

CELICA BODY

	page
FRONT BODY	3- 2
REAR BODY (HARDTOP)	3- 8
REAR BODY (LIFTBACK)	3-11
FRONT DOOR	3-15
QUARTER WINDOW (HARDTOP)	3-24
QUARTER WINDOW (LIFTBACK)	3-30
WINDSHIELD	3-34
INTERIOR	3-39
INSTRUMENT PANEL	3-42
IMPORTANT BODY DIMENSIONS	3-47

FRONT BODY

Fig. 3-1

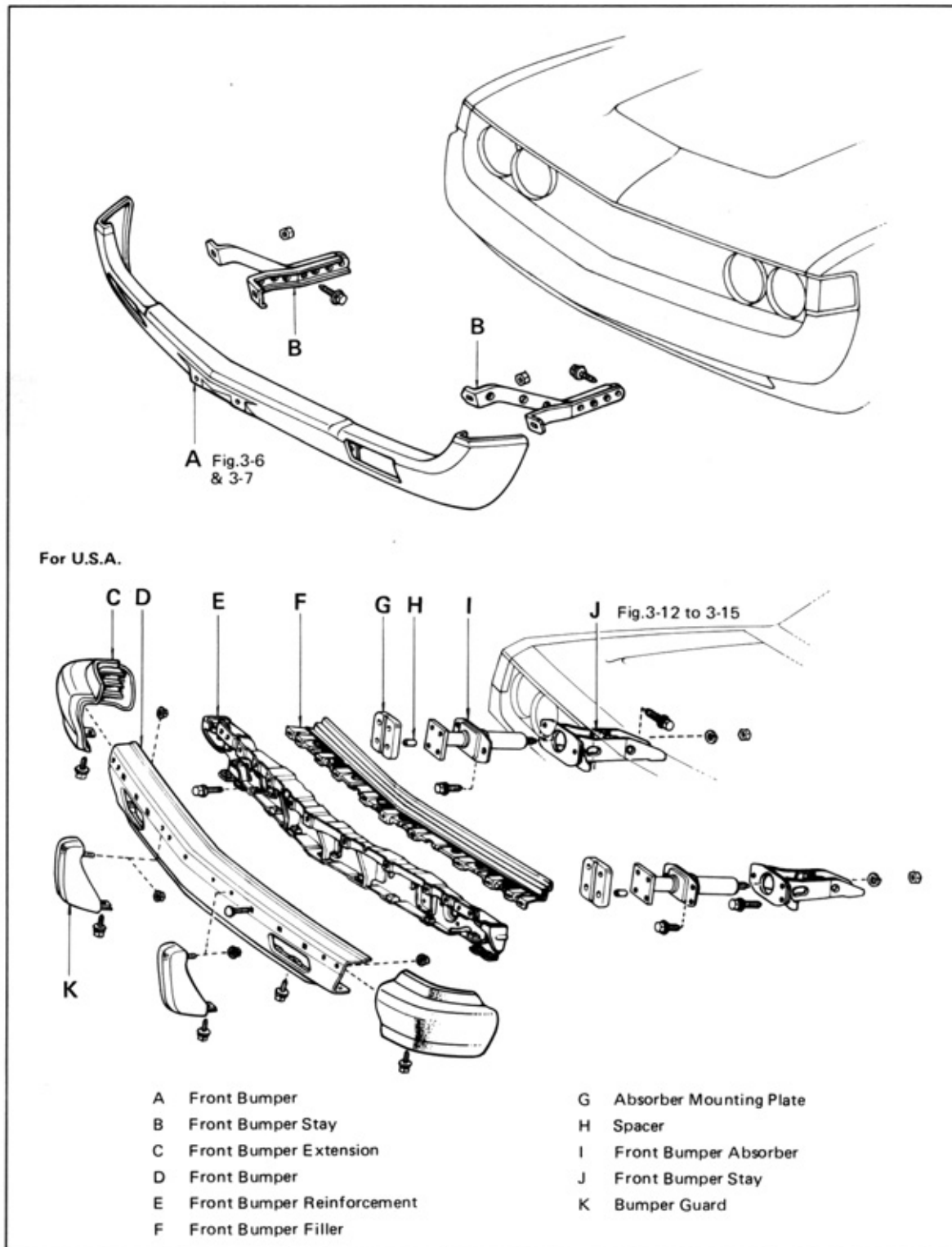


Fig. 3-2

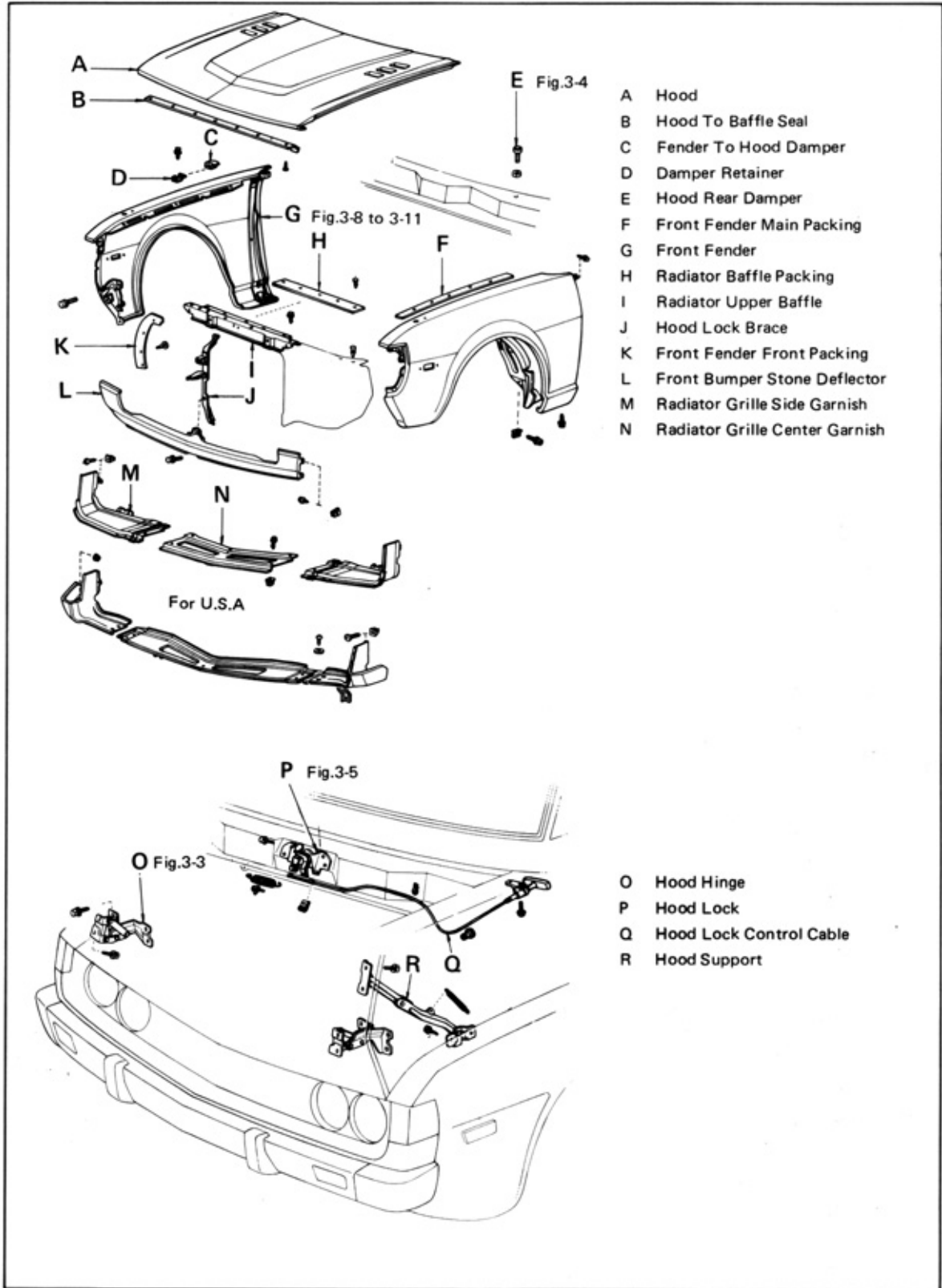


Fig. 3-3

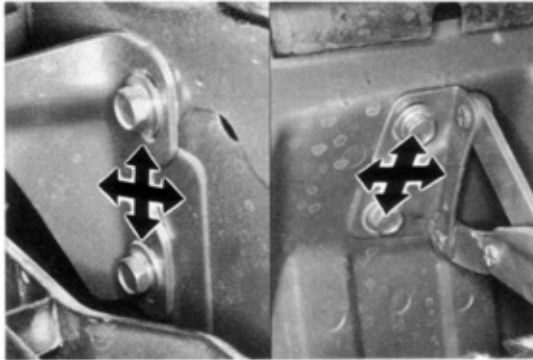


Fig. 3-4

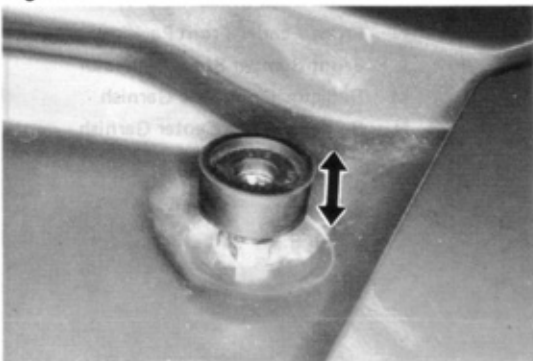
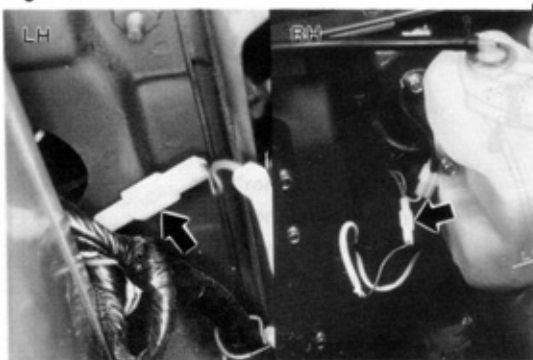


Fig. 3-5



Fig. 3-6



HOOD ADJUSTMENT

1. Vertical adjustment of the hood front end is made by loosening the hinge bolts at the body.
2. Hood forward and backward adjustment is made by loosening the hinge bolts at the hood.
3. Hood lateral adjustment is made by loosening the hinge bolts at both the body and hood.
4. Vertical adjustment of the hood rear end is made by varying the heights of the hood lock and hood rear dampers.

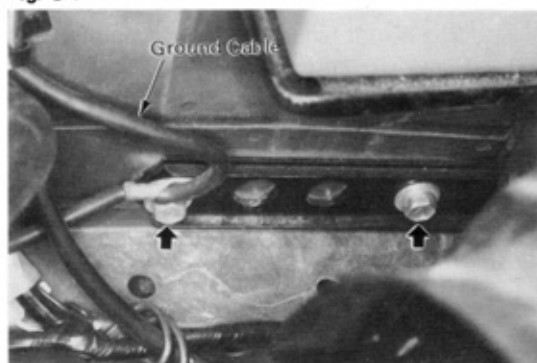
HOOD LOCK ADJUSTMENT

Check the hood to see that it is in proper adjustment and fitting correctly.

FRONT BUMPER REMOVAL (EXCEPT USA)

1. Disconnect front turn signal light wiring connectors.

Fig. 3-7

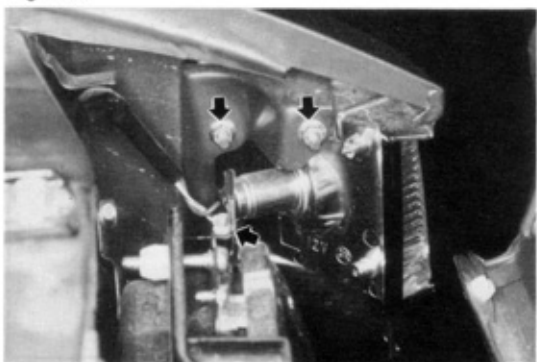


2. Remove front bumper stay set bolts
Battery ground cable is also bolted down with the same bumper stay set bolt so when installing the bumper stay, do not forget to bolt together the ground bolt.
3. Remove front bumper
Pull out the front bumper with turn signal lights and stays attached.

FRONT BUMPER INSTALLATION

Perform the removal in reverse order.

Fig. 3-8



FRONT FENDER REMOVAL

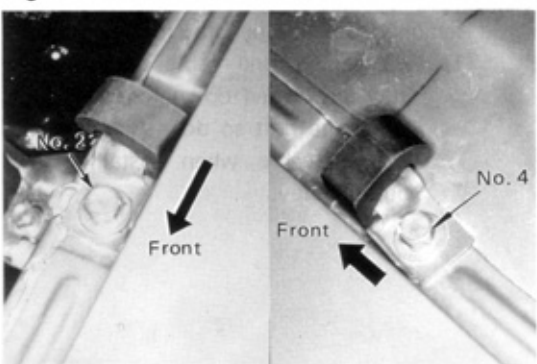
1. Remove front bumper
Perform first 3 steps in Front Bumper Removal (except USA) pages 3-4 & 3-5.
2. Remove radiator grille center and side garnishes.
3. Remove front parking light.
4. Disconnect side turn signal light wiring connector.

Fig. 3-9



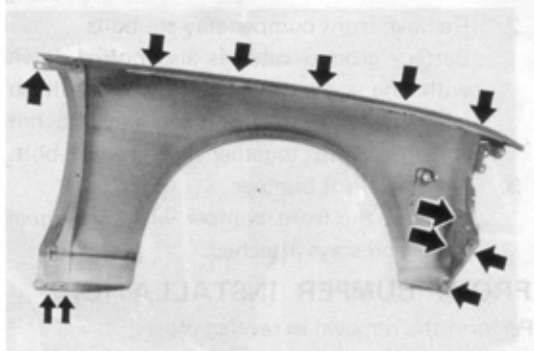
5. Remove front fender splash shield.
6. Remove locker panel moulding.

Fig. 3-10



7. Remove fender mounting bolts
 - (1) Out of the five bolts mounting the upper side of front fender, the retainer and damper are installed with the No.2 and No.4 bolts as illustrated.

Fig. 3-11

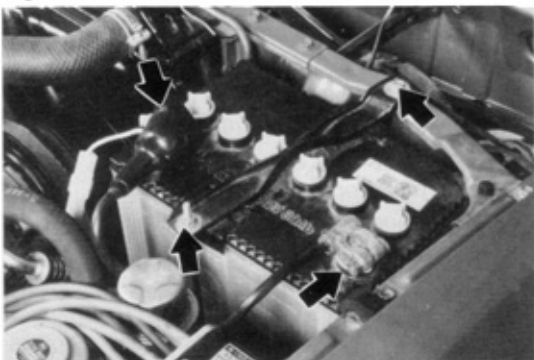


- (2) Front fender installation points.
8. Remove front fender.

FRONT FENDER INSTLLATION

Perform the removal in reverse order.

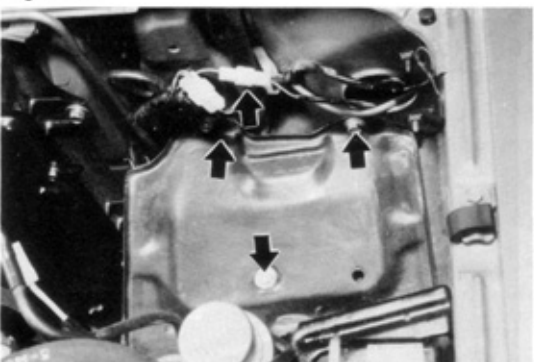
Fig. 3-12



FRONT BUMPER REMOVAL (FOR USA)

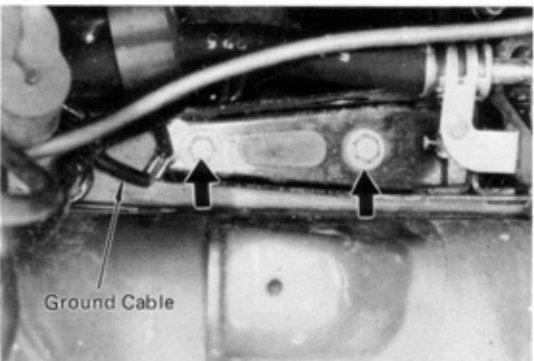
1. Remove battery and battery carrier. (disconnect ground first).

Fig. 3-13



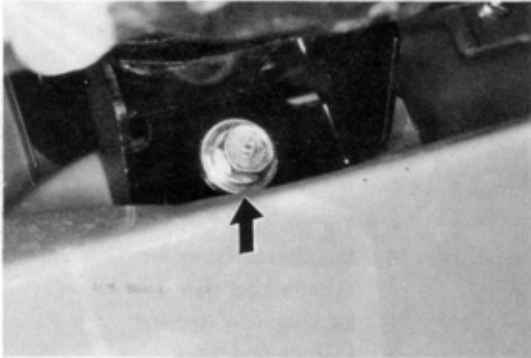
2. Disconnect front turn signal light wiring connectors.

Fig. 3-14



3. Remove front bumper stay mounting bolts
(1) Battery ground cable and bumper stay are bolted down together with the same bolt so do not forget the ground cable when installing the bumper stay.

Fig. 3-15



- (2) Front bumper stay is also mounted to the body from the outer side.
4. Remove front bumper
Pull out the front bumper with turn signal lights and stays attached.

FRONT BUMPER INSTALLATION

Perform the removal in reverse order.

FRONT FENDER REMOVAL (FOR USA)

1. Remove front bumper
Perform first 4 steps in Front Bumper Removal (for USA) page 3-6.
2. Remove front fender
Perform steps 2 to 8 in Front Fender Removal page 3-5.

**SEE
FRONT BUMPER REMOVAL
(FOR USA) PAGE 3-6 & FRONT
FENDER REMOVAL PAGE 3-5**

REAR BODY (HARDTOP)

Fig. 3-16

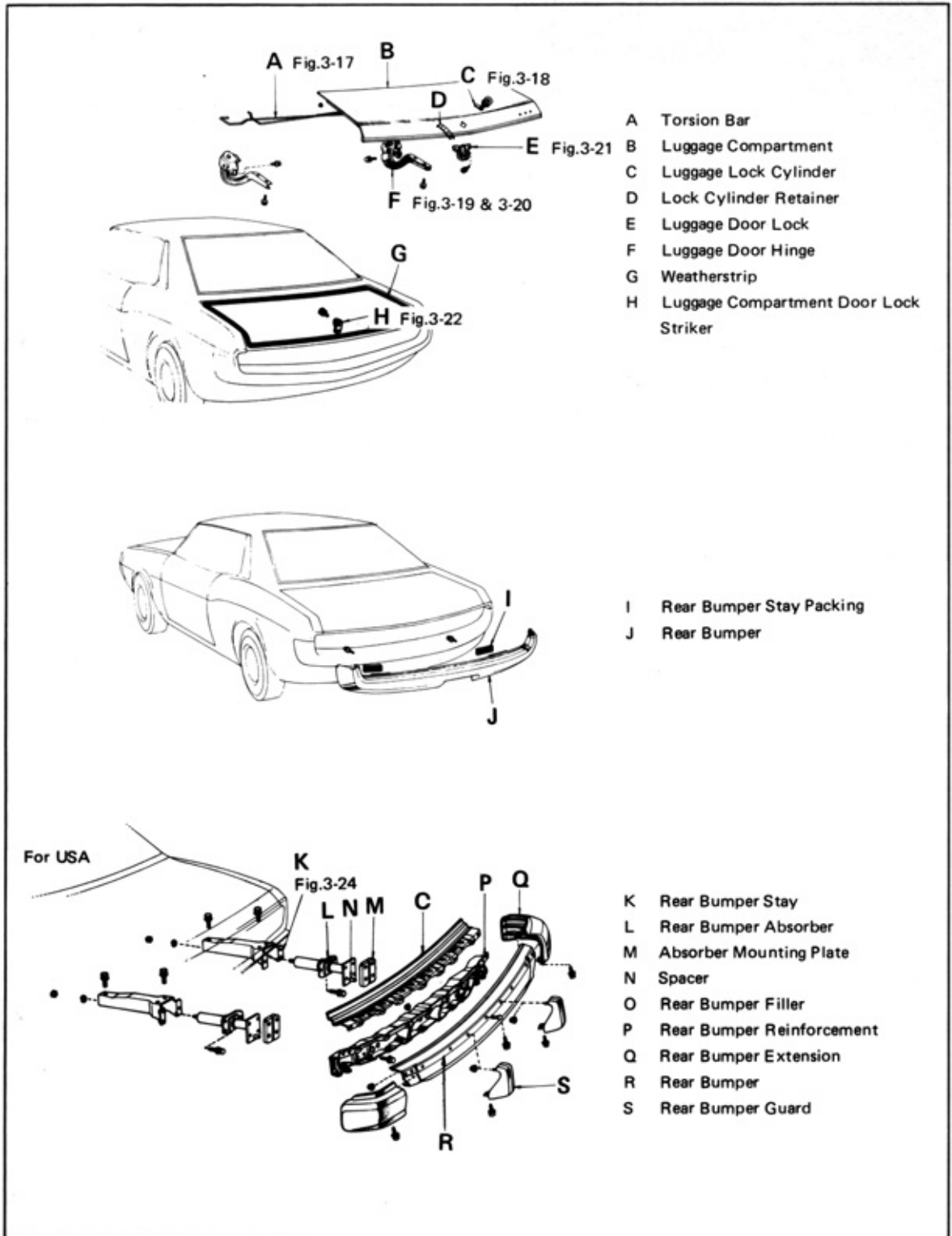
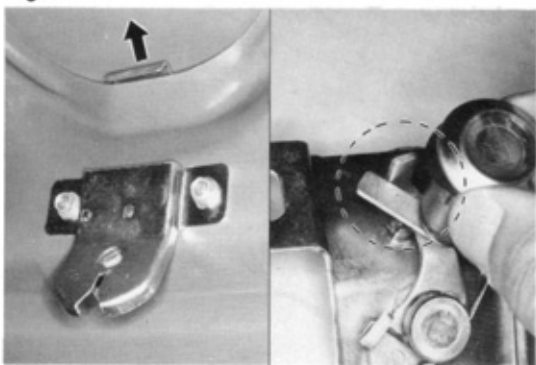


Fig. 3-17

**TORSION BAR REPLACEMENT**

Use SST [09805-20011] , when removing or installing the torsion bar.

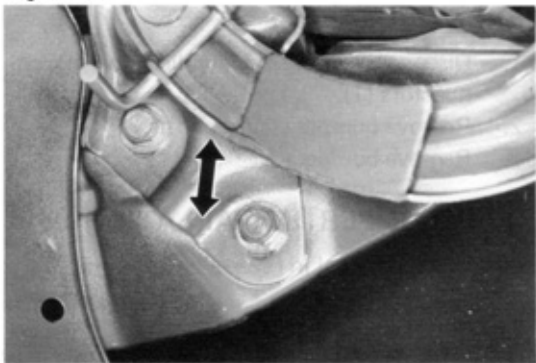
Fig. 3-18

**LUGGAGE DOOR LOCK CYLINDER REPLACEMENT**

1. Remove retainer.
2. Remove lock cylinder.
3. Install new lock cylinder.

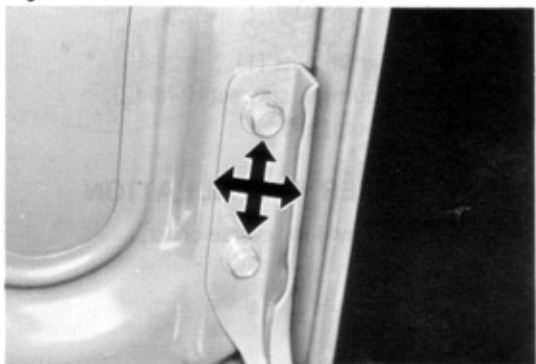
Install so that the relative positions of the door lock and lock cylinder will be as shown.

Fig. 3-19

**LUGGAGE COMPARTMENT DOOR ADJUSTMENT**

1. Vertical adjustment of the luggage compartment door front end is made by loosening the hinge bolts at the body.

Fig. 3-20



2. Luggage compartment door forward, backward, and sideways adjustments are made by loosening the hinge bolts at the door.

Fig. 3-21

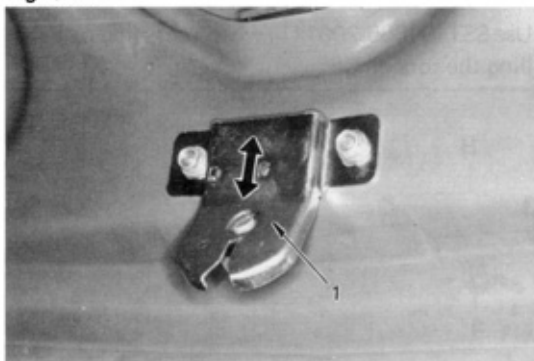


Fig. 3-22

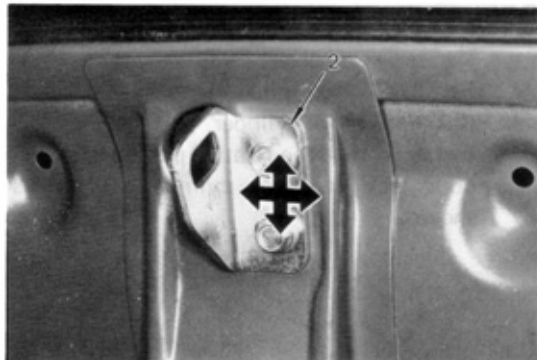


Fig. 3-23

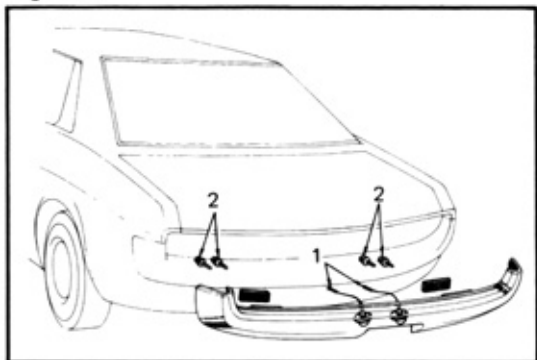
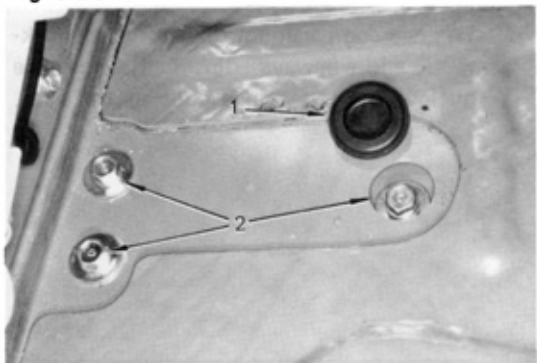


Fig. 3-24



LUGGAGE COMPARTMENT DOOR LOCK ADJUSTMENT

1. In case the door does not lock properly, shift part (1) vertically and part (2) sideways.
2. In case the door has excessive vertical looseness when closed, correct by shifting part (1) up or down.

REAR BUMPER REMOVAL (EXCEPT USA)



1. Disconnect license plate light wiring connectors (1).
2. Remove bumper stay set bolts.
3. Remove bumper.

REAR BUMPER INSTALLATION

Perform the removal in reverse order.

REAR BUMPER REMOVAL (FOR USA)



1. Remove grommets (1).
2. Remove bumper stay set bolts (2).
3. Remove bumper.

REAR BUMPER INSTALLATION

Perform the removal in reverse order.

REAR BODY (LIFTBACK)

Fig. 3-25

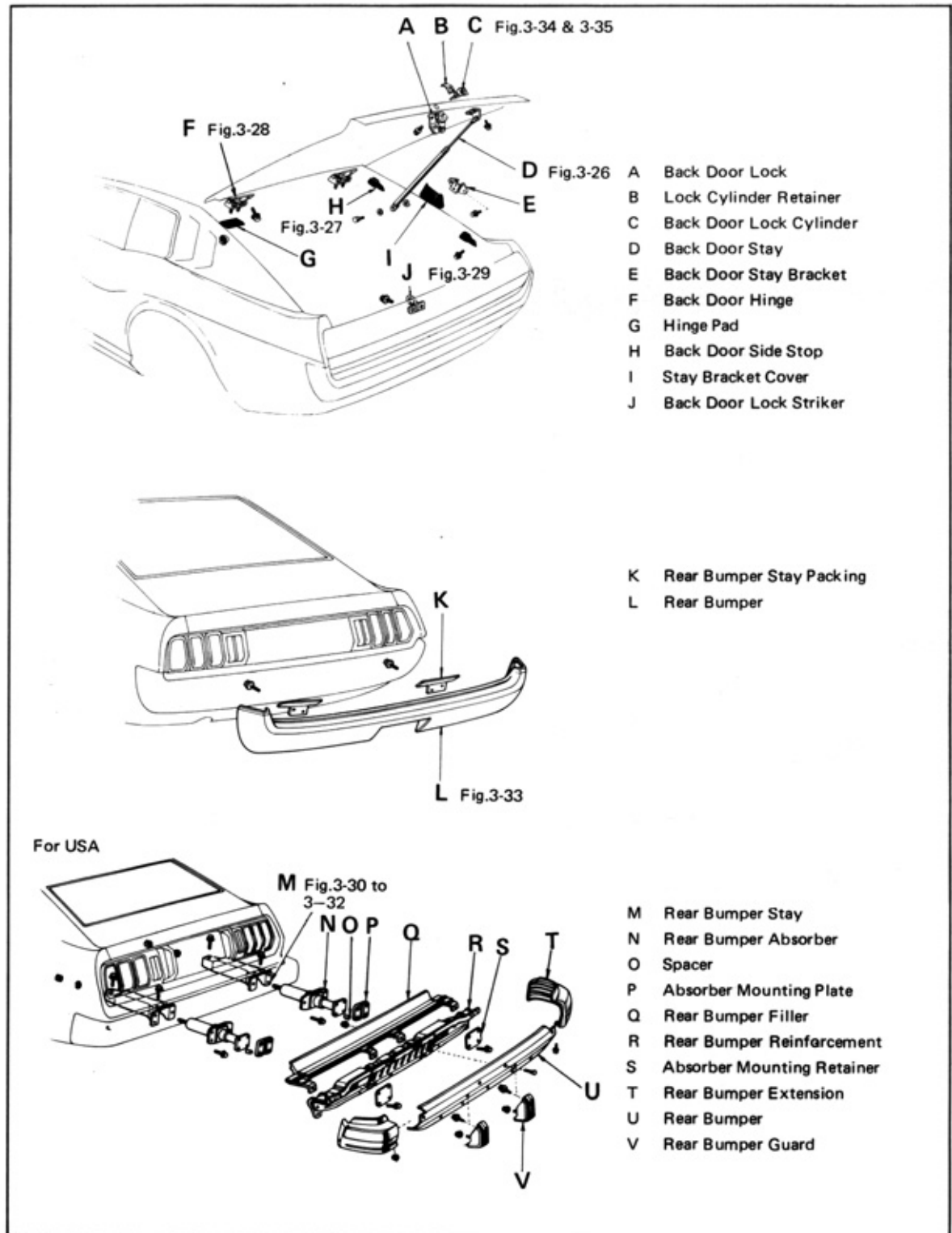


Fig. 3-26

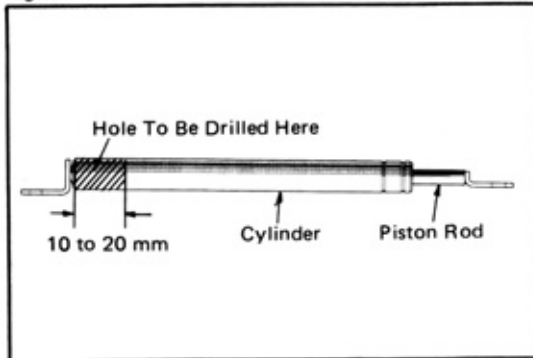


Fig. 3-27

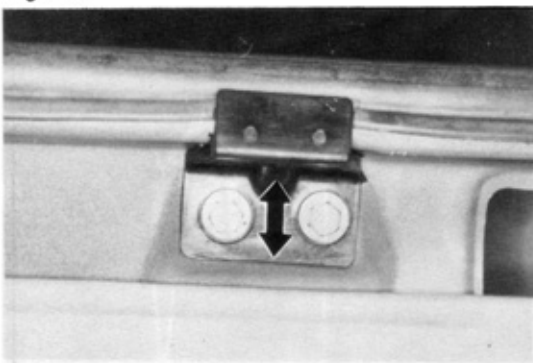


Fig. 3-28

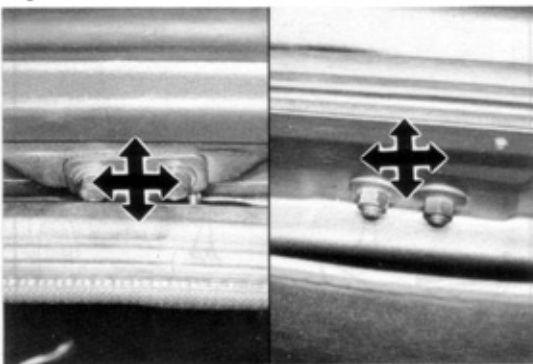
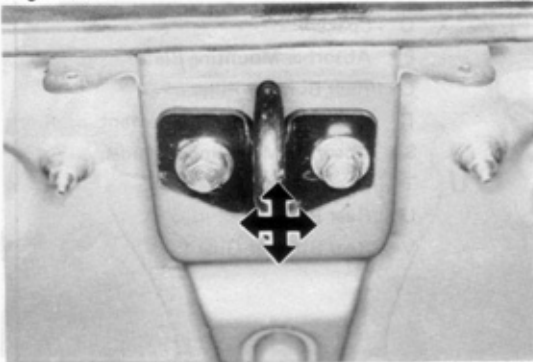


Fig. 3-29



PRECAUTIONS ON HANDLING DAMPER STAY

1. Do not disassemble the damper stay as it is filled with gas.
2. When the damper stay is replaced, before discarding the old damper stay, bore a 2 or 3 mm hole at the lower end of cylinder and allow the high pressure gas to escape. (This gas is colorless, odorless, and non-poisonous, but use care when venting it out as the drill cuttings and oil may fly out with considerable force.)
3. When installing, use special care not to damage the exposed part of piston rod or allow paint, oil, or other foreign to get on it.
4. Do not turn the piston rod or cylinder when the damper stay is fully extended.

BACK DOOR ADJUSTMENT

1. Vertical adjustment of the back door is made by loosening the bolts attaching the back door outside stopper.
2. Forward-backward and lateral adjustments of the back door is made by loosening the nuts mounting the hinge to the body, or the bolts mounting the hinge to the door.

BACK DOOR LOCK ADJUSTMENT

If the door lock does not catch properly, correct by shifting the striker vertically or laterally.

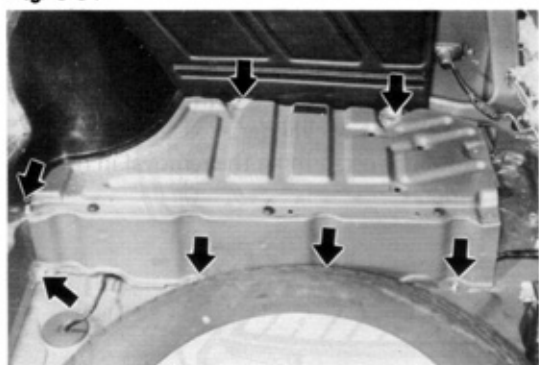
Fig. 3-30



**REAR BUMPER REMOVAL
(FOR USA)**

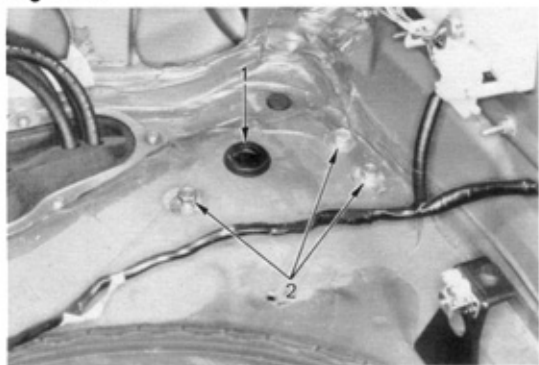
1. Open up the carpet and deck board (1). Follow the procedure for removing spare tire.
2. Remove lower back panel cover (2). Remove the attaching screws and take off the lower back panel cover by deforming it, but using care not to tear it.

Fig. 3-31



3. Remove the right deck board bracket. Clamps for wire harness are on the inner side.

Fig. 3-32

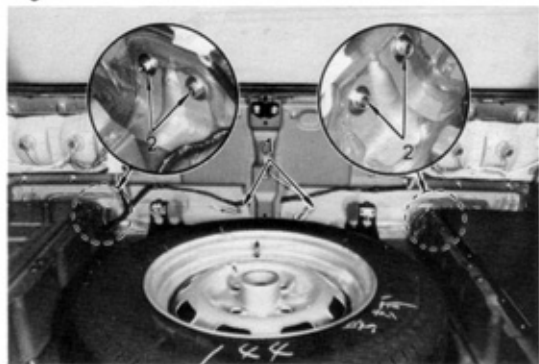


4. Remove bumper mounting bolts.
 - (1) Take off the grommets (1) and remove the bolts (2).
 - (2) Pull out the rear bumper to the rear.

REAR BUMPER INSTALLATION

Perform the removal in reverse order.

Fig. 3-33



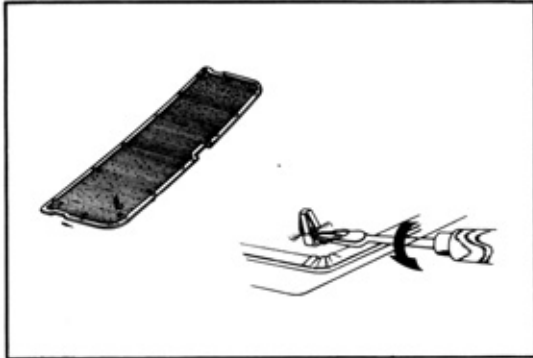
**REAR BUMPER REMOVAL
(EXCEPT USA)**

1. Remove lower back panel cover. Perform first 2 steps in Rear Bumper Removal (for USA) above.
2. Disconnect license plate light wiring connector (1).
3. Remove bumper mounting bolts (2).

REAR BUMPER INSTALLATION

Perform the removal in reverse order.

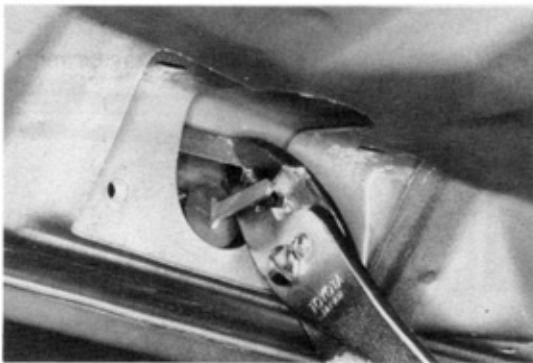
Fig. 3-34



BACK DOOR LOCK CYLINDER REPLACEMENT

1. Remove back door trim board.
Use flat end screwdriver and pry off trim board back side retainers from back door panel.

Fig. 3-35



2. Remove back door lock.
3. Remove back door lock cylinder.
Remove the retainer with pliers and take out door lock cylinder.
4. Install by performing the removal in reverse order.

FRONT DOOR

Fig. 3-36

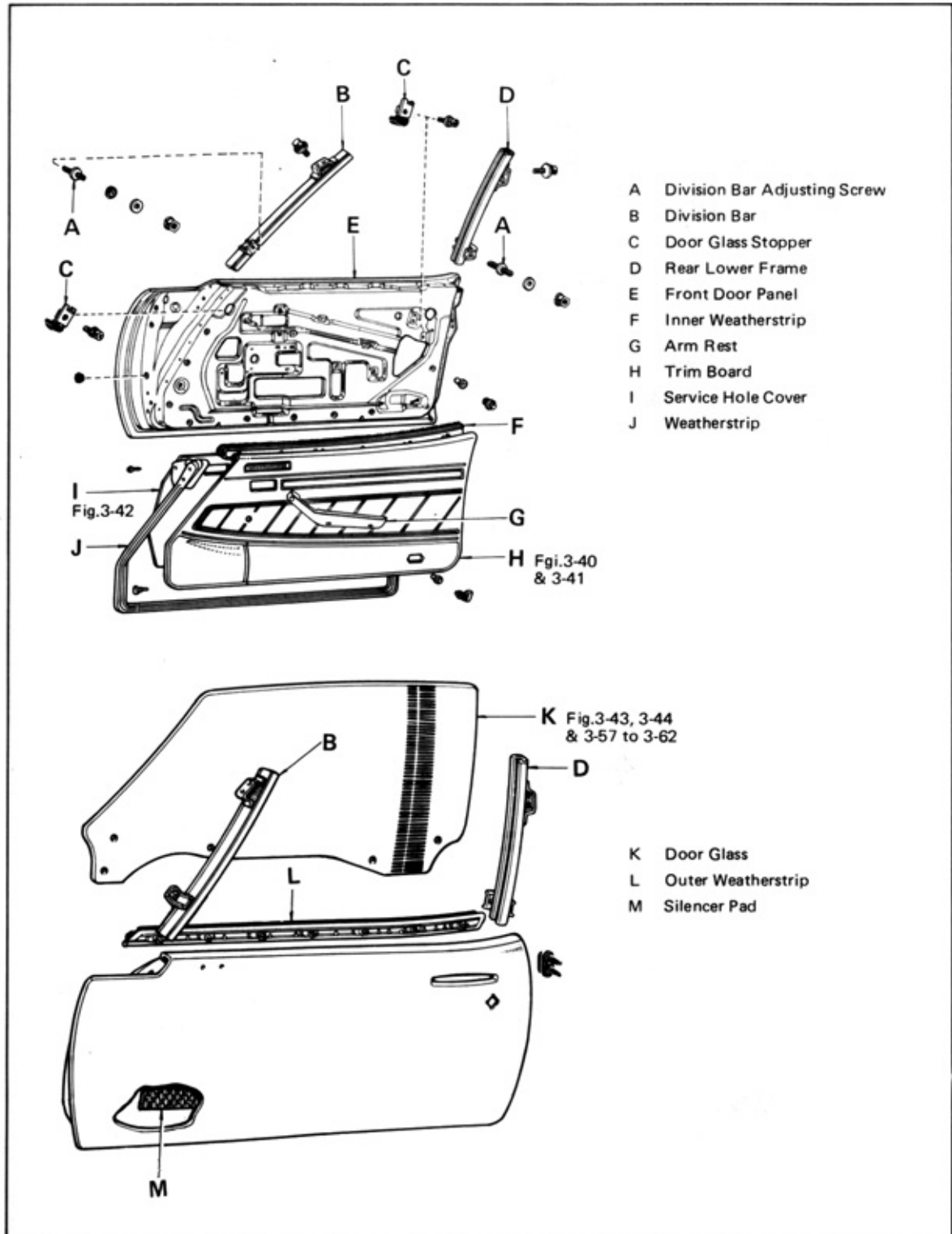


Fig. 3-37

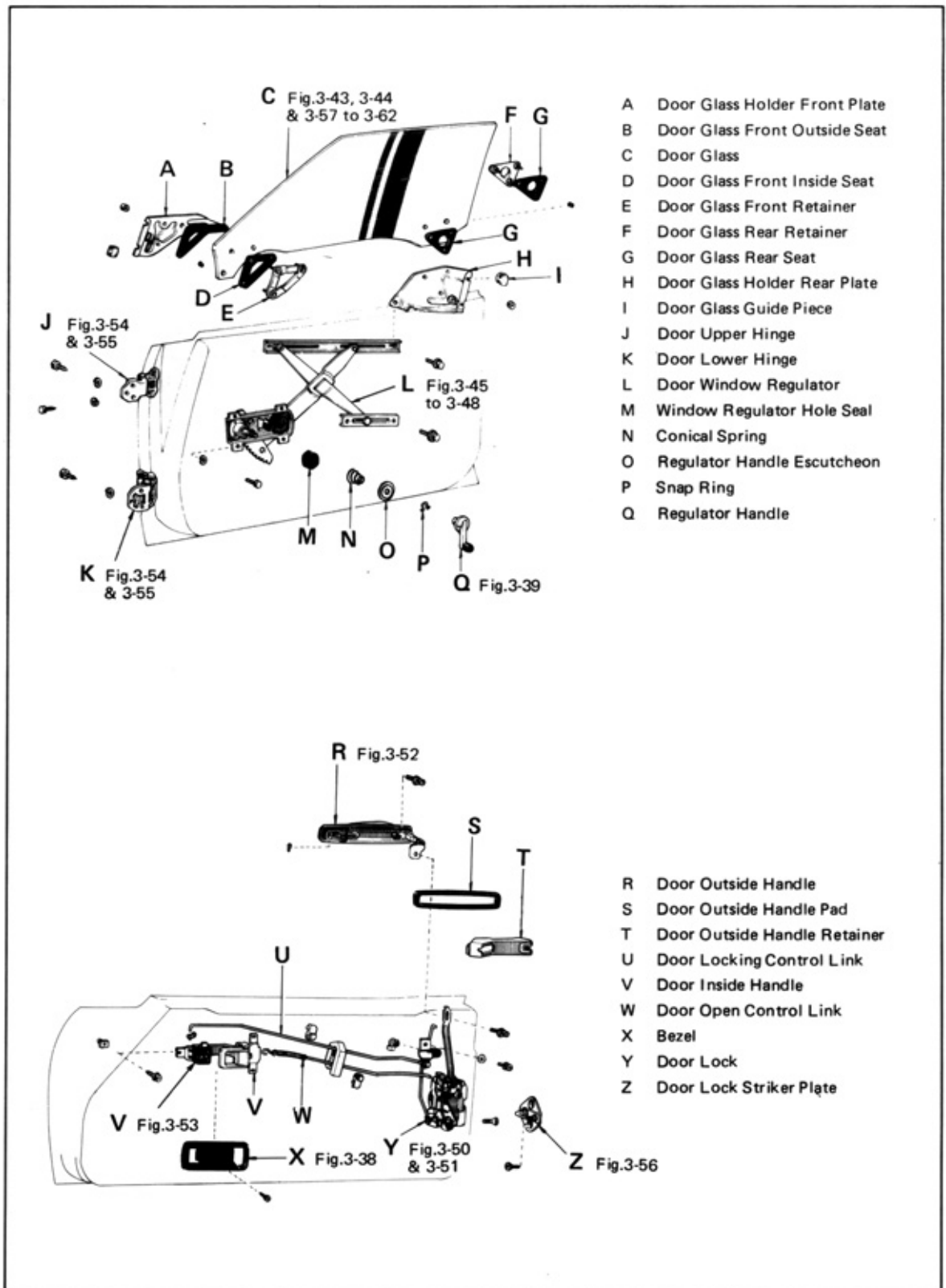
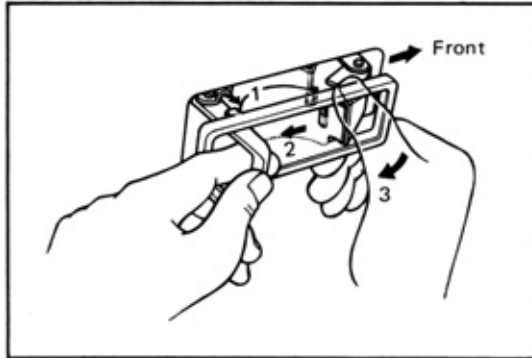


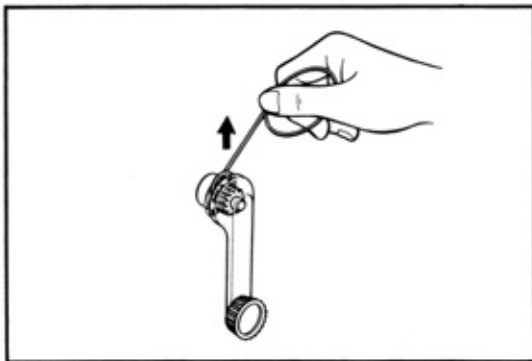
Fig. 3-38



FRONT DOOR TRIM REMOVAL

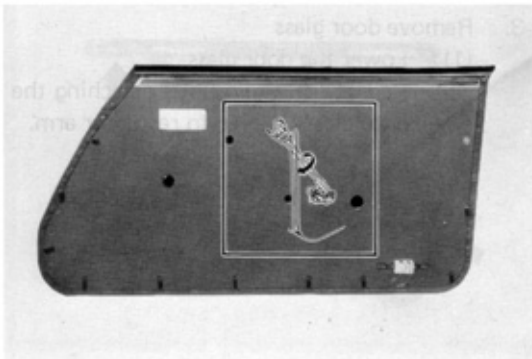
1. Remove inside handle bezel
Loosen the lips at back side of bezel, and take out bezel from the front side.
2. Remove arm rest
Take off blind cover, loosen three screws installing arm rest, and take off arm rest.

Fig. 3-39



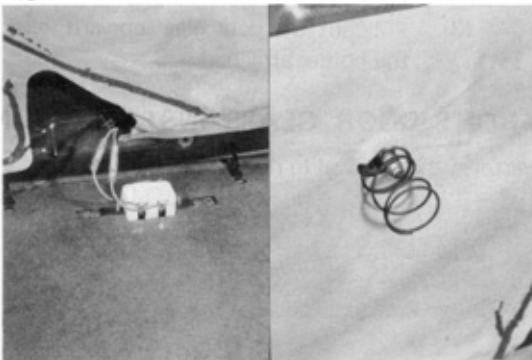
3. Remove window regulator handle
Pull out the snap ring with a wire or other means, and take off the handle.

Fig. 3-40



4. Remove door trim
(1) Place the tip of screwdriver against the retainer and pull out the retainer through the door panel opening.

Fig. 3-41



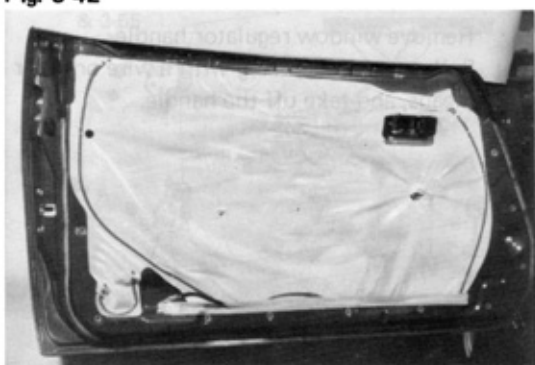
- (2) Disconnect the courtesy light wiring connectors.
- (3) Remove the regulator handle conical spring.

FRONT DOOR TRIM INSTALLATION

Perform the removal in reverse order.

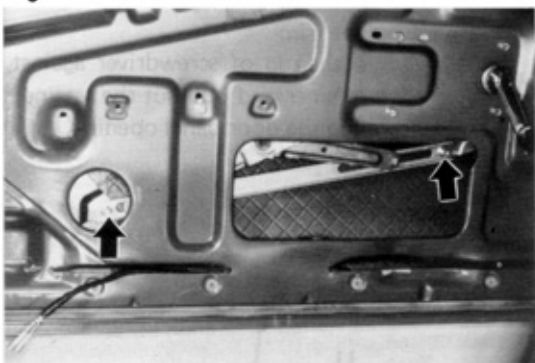
SEE
FRONT DOOR TRIM
REMOVAL PAGE 3-17

Fig. 3-42



2. Peel off service hole cover.

Fig. 3-43



3. Remove door glass
 - (1) Lower the door glass.
 - (2) Remove the two bolts attaching the door glass channel to regulator arm.

Fig. 3-44



- (3) Pull out the door glass upward with the holder attached.

FRONT DOOR GLASS INSTALLATION

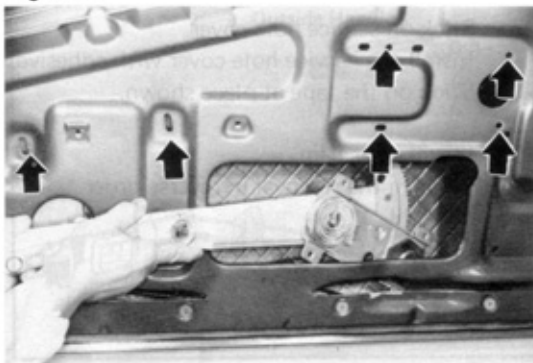
Perform the removal in reverse order.

SEE
FRONT DOOR TRIM REMOVAL
PAGE 3-17 & FRONT DOOR
GLASS REMOVAL PAGE 3-18

FRONT DOOR WINDOW REGULATOR REPLACEMENT

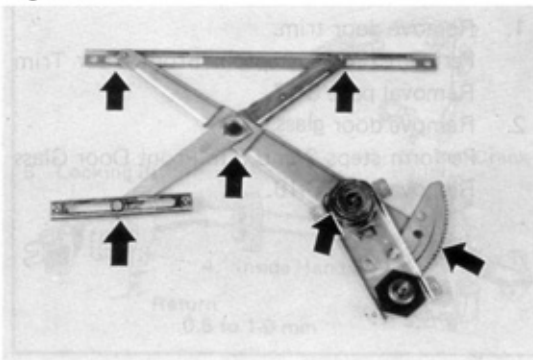
1. Remove door trim
Perform first 4 steps in Front Door Trim Removal page 3-17.
2. Remove door glass
Perform steps 2 and 3 of Front Door Glass Removal page 3-18.

Fig. 3-45



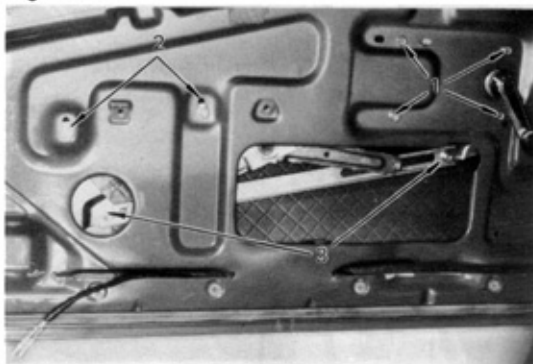
3. Remove regulator
Remove the six bolts mounting the window regulator, and take out the regulator.

Fig. 3-46



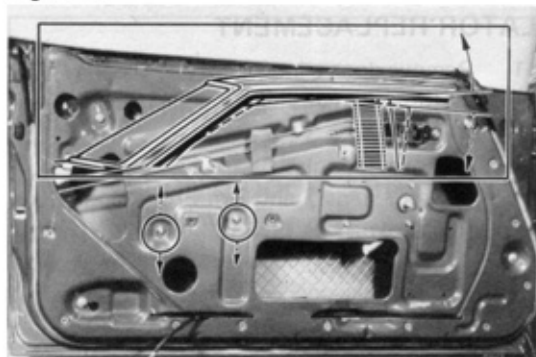
4. Inspect regulator
 - (1) Inspect the regulator gears for wear and damage, spring for deterioration and breakage, and other parts for damage, and if necessary, replace the door window regulator assembly.
 - (2) Lubricate the regulator, as necessary, with MP grease.

Fig. 3-47



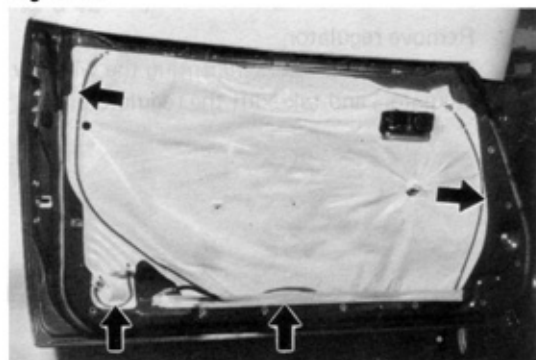
5. Install regulator
Mount the regulator with bolts (1), and leave bolts (2) finger tight.
6. Install door glass
 - (1) With the window regulator lowered all the way down, install the bolts (3) attaching the glass channel to regulator arm.

Fig. 3-48



- (2) Raise the door glass until just before contacting the stopper, and after positioning so that there is no forward or backward tilt, tighten the bolts (2) installing the equalizer arm bracket.

Fig. 3-49



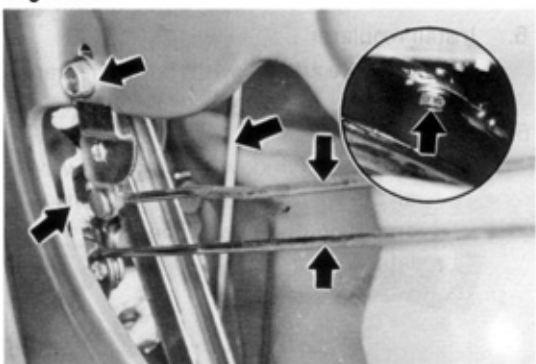
7. Stick on service hole cover. Install the service hole cover with adhesive. Stick on the tape at place shown.
8. Install door trim. Perform the removal in reverse order.

SEE
**FRONT DOOR TRIM REMOVAL
 PAGE 3-17 & FRONT DOOR
 GLASS REMOVAL PAGE 3-18**

FRONT DOOR LOCK REPLACEMENT

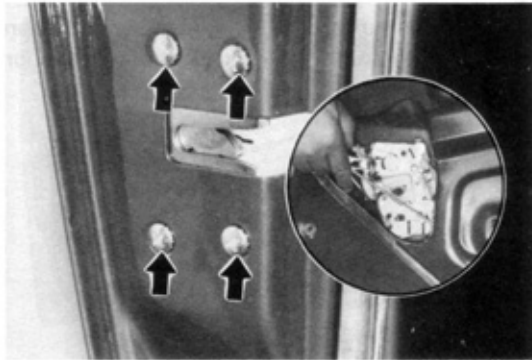
1. Remove door trim. Perform first 4 steps in Front Door Trim Removal page 3-17.
2. Remove door glass. Perform steps 2 and 3 in Front Door Glass Removal page 3-18.

Fig. 3-50



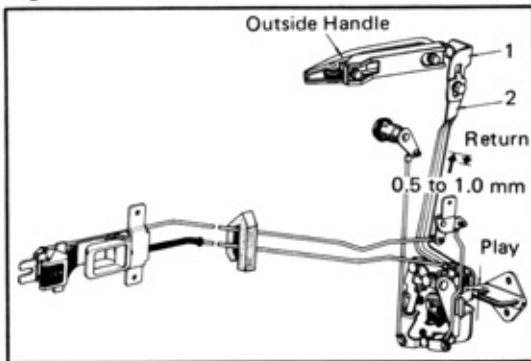
3. Remove door lock.
 - (1) Disconnect the linkages from the door lock.

Fig. 3-51



- (2) Remove the door lock mounting screws, and take off the door lock.
4. Install the door lock by performing the removal in reverse order.

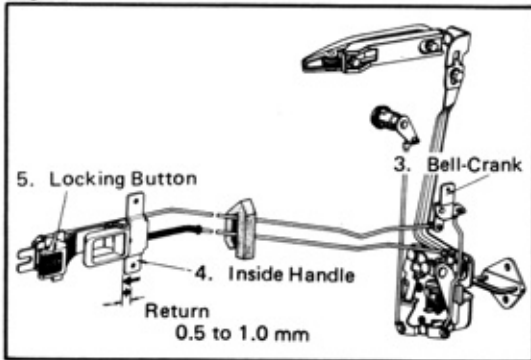
Fig. 3-52



FRONT DOOR OUTSIDE HANDLE PLAY ADJUSTMENT

Pull up the part (2) attached to the door lock as far as it will go. Then return it down 0.5 to 1.0 mm (0.02 to 0.04 in) and install it securely to part (1) at this position.

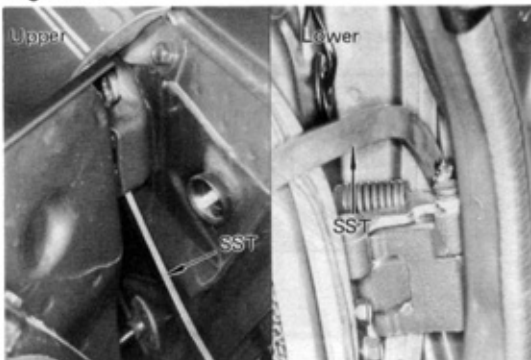
Fig. 3-53



FRONT DOOR INSIDE HANDLE PLAY ADJUSTMENT

1. Tighten down part (3) finger-tight.
2. Shift part (4) forward and then return it 0.5 to 1.0 mm (0.02 to 0.04 in) from the point where the resistance suddenly increases and tighten (4) securely.
3. Place part (5) in locked position, and while pressing down on (5), tighten (3) securely.

Fig. 3-54



FRONT DOOR ADJUSTMENT

1. Make the adjustment in front-rear and left-right directions by loosening the hinge bolts at the body side. Use SST [09812-14010].

Fig. 3-55

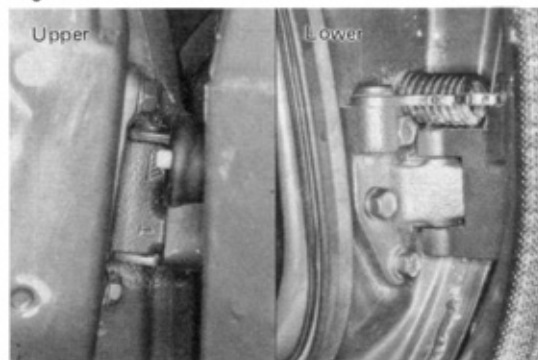


Fig. 3-56

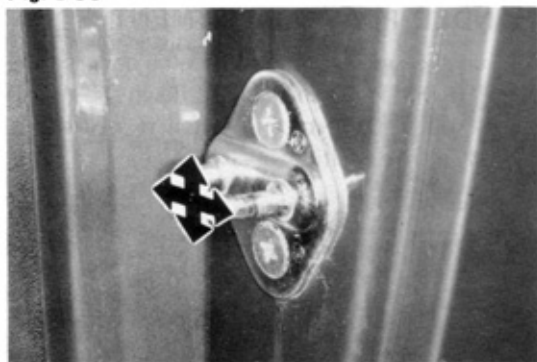


Fig. 3-57



Fig. 3-58

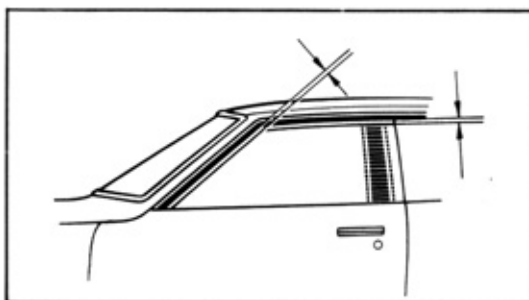


2. Make the adjustment in vertical direction by loosening the hinge bolts at the door side.

3. Correct improper door closure by adjusting the door lock striker.

FRONT DOOR GLASS ADJUSTMENT

1. When entire glass is sagging.



2. When there is gap at glass front side.

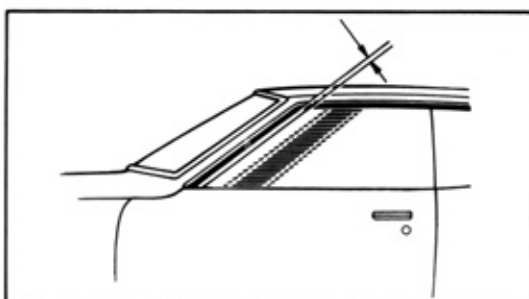
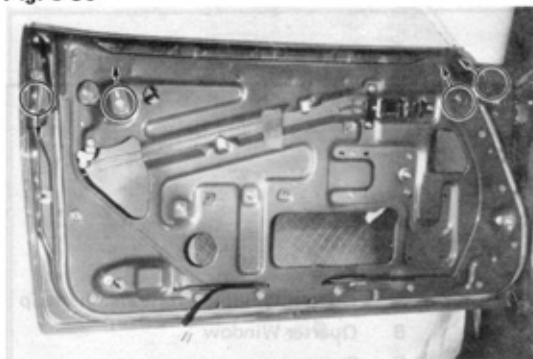


Fig. 3-59



3. When there is gap at glass top side.

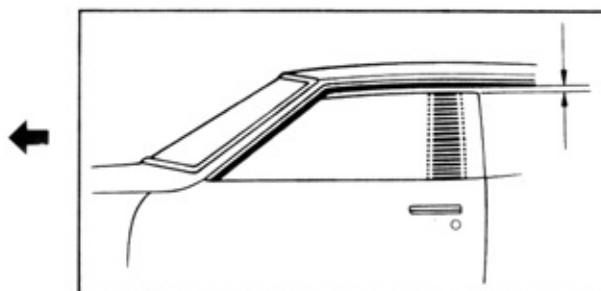
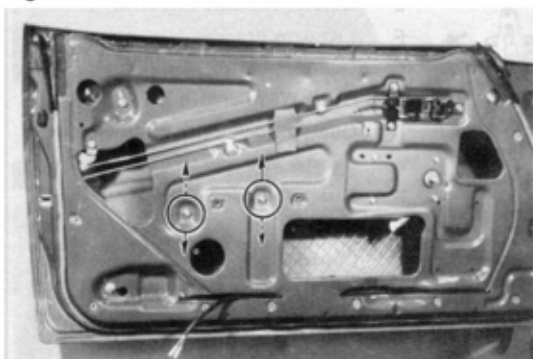


Fig. 3-60



4. When glass is tilted in longitudinal direction.

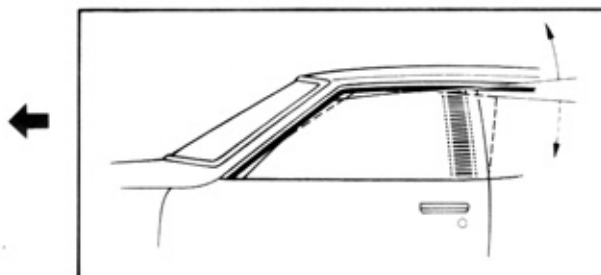


Fig. 3-61



5. When there is excessive looseness in lateral direction.

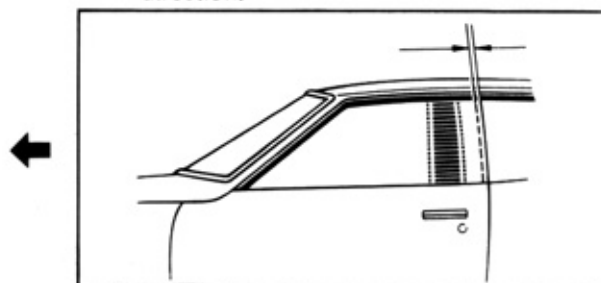
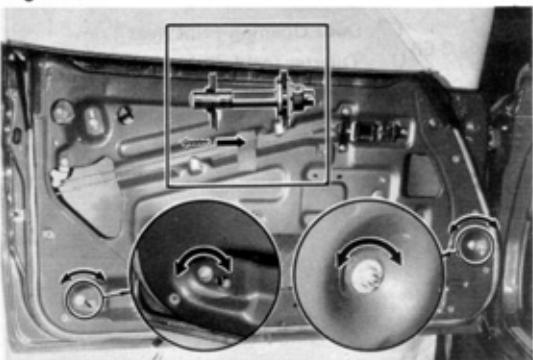
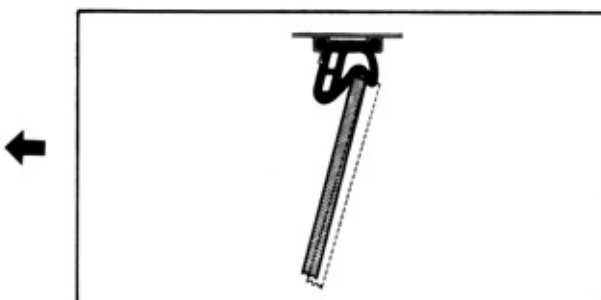


Fig. 3-62



6. When glass is not flush with weatherstrip.



QUARTER WINDOW (HARDTOP)

Fig. 3-63

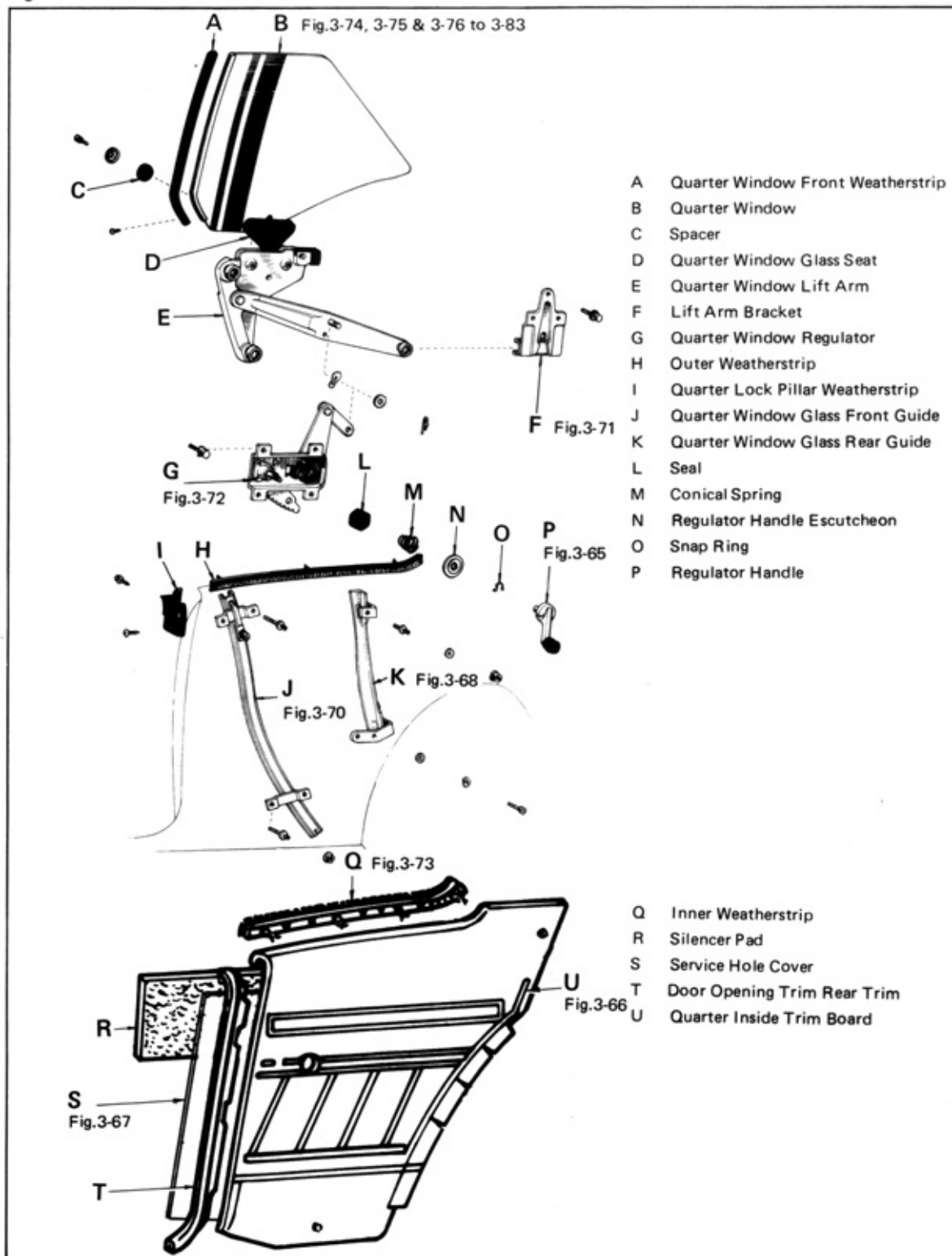
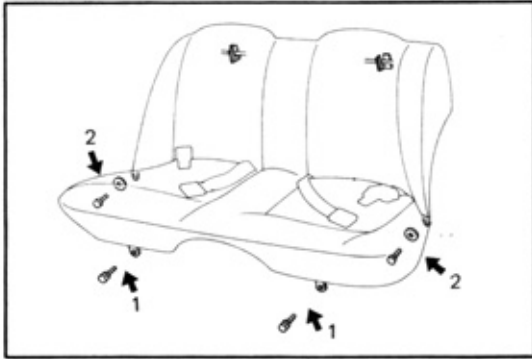


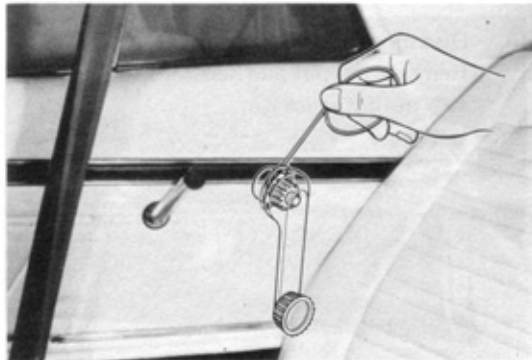
Fig. 3-64



QUARTER WINDOW GLASS REMOVAL

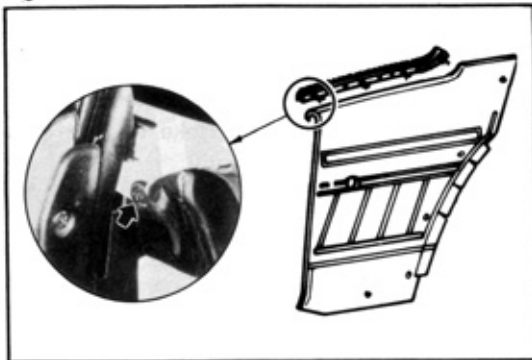
1. Remove rear seat cushion and seat back.
 - (1) Remove the two bolts fastening the rear seat cushion to floor pan, and take off the rear seat cushion.
 - (2) Loosen the two bolts fastening the seat back to quarter wheel house, and take out the seat back by raising it upward.

Fig. 3-65



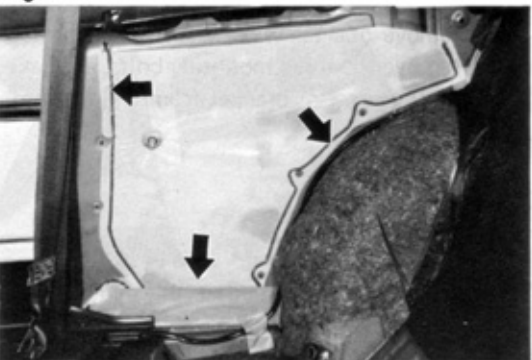
2. Remove door window regulator handle
Pull out the snap ring with a wire or other means, and take off the handle.

Fig. 3-66



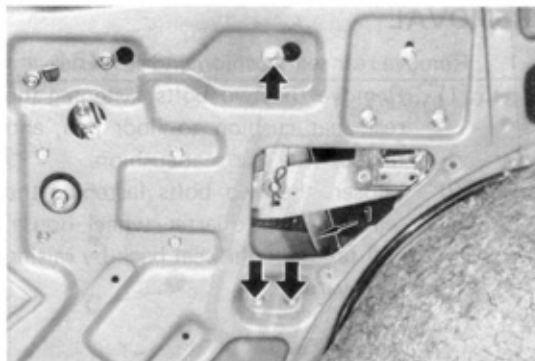
3. Remove quarter trim panel.
 - (1) From the outside, remove the screw attaching the upper front part of the quarter trim.
 - (2) Remove the retainers attaching the trim, and take off the quarter trim panel.

Fig. 3-67



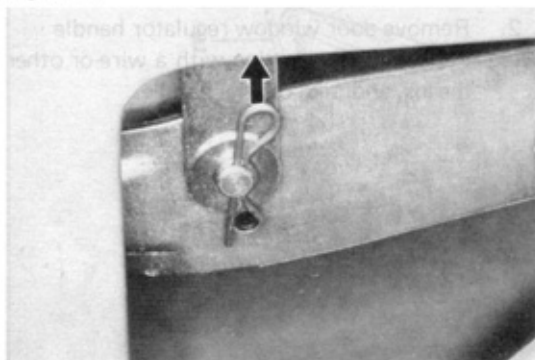
4. Peel off service hole cover.

Fig. 3-68



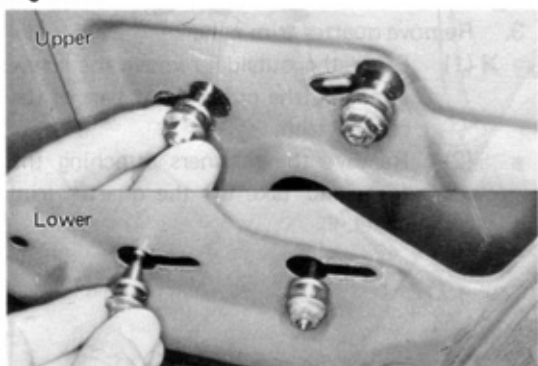
5. Remove quarter window glass rear guide (1).
Remove the window glass rear guide by loosening its three installing bolts.

Fig. 3-69



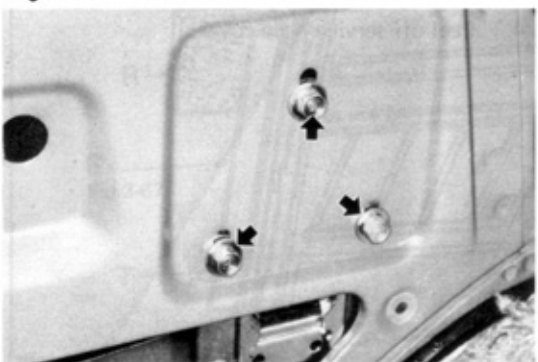
6. Disconnect regulator arm
Remove the pin and separate the regulator arm from the lift arm.

Fig. 3-70



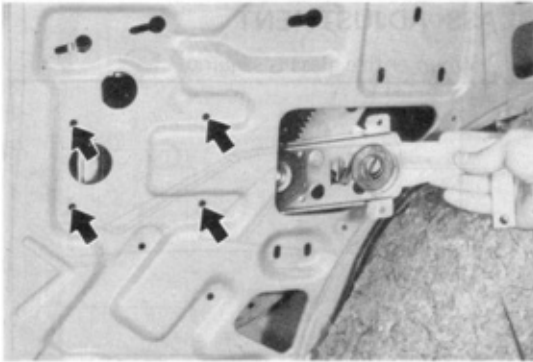
7. Remove quarter window glass front guide mounting bolts.
Remove the four stud bolts used to adjust the quarter glass, and take off the glass front guide from the body.

Fig. 3-71



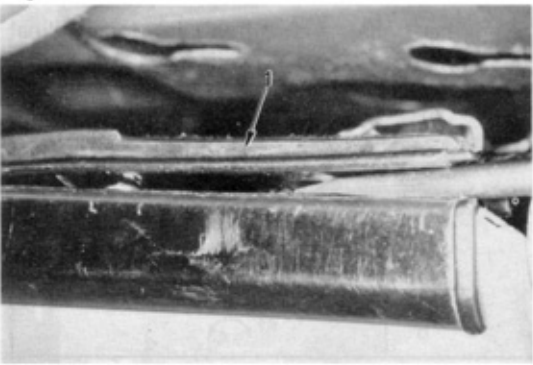
8. Remove quarter window lift arm bracket.
Remove the three mounting bolts, and take off the lift arm bracket from the lift arm.

Fig. 3-72



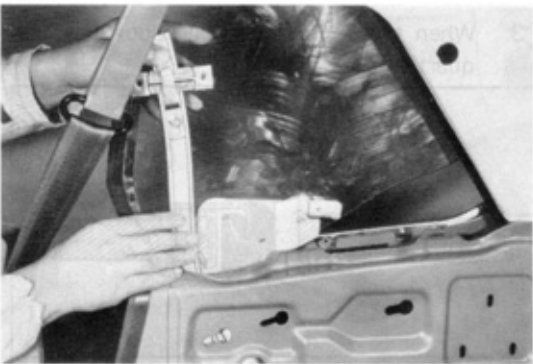
9. Remove quarter window regulator. Remove the four mounting bolts and take out the quarter window regulator through the service hole.

Fig. 3-73



10. Remove quarter window glass outer weatherstrip (1). Use flat tip screwdriver for removing.

Fig. 3-74



11. Remove quarter window glass. Lift up the quarter window glass with the quarter window arm and glass front guide attached, and take off the quarter window glass.

Fig. 3-75



QUARTER WINDOW GLASS INSTALLATION

Perform the removal in reverse order.

Fig. 3-76



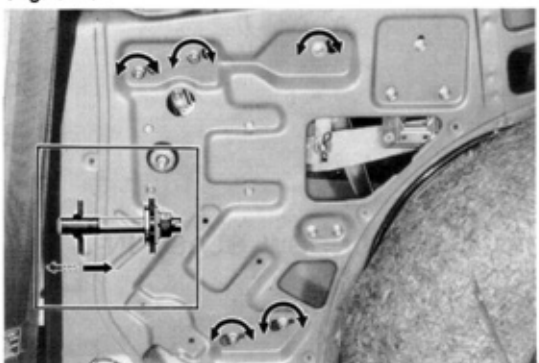
Fig. 3-77



Fig. 3-78

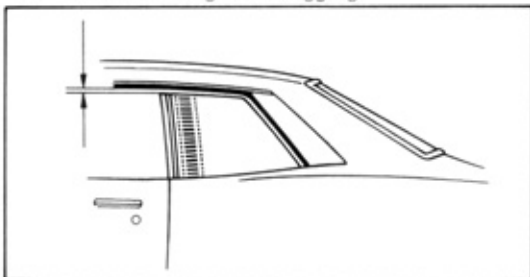


Fig. 3-79

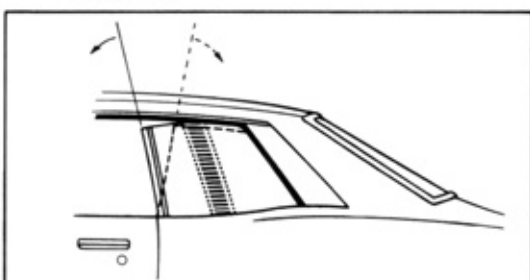


REAR QUARTER WINDOW GLASS ADJUSTMENT

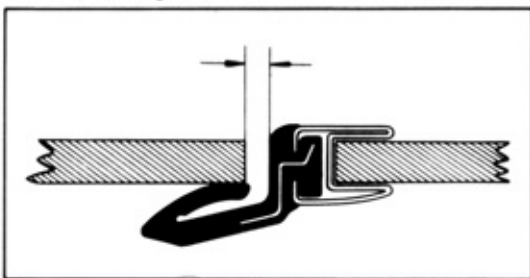
1. When entire glass is sagging.



2. When glass is tilted in longitudinal direction.



3. When there is gap between door glass and quarter glass.



4. When door glass and quarter glass are not flush with each other.

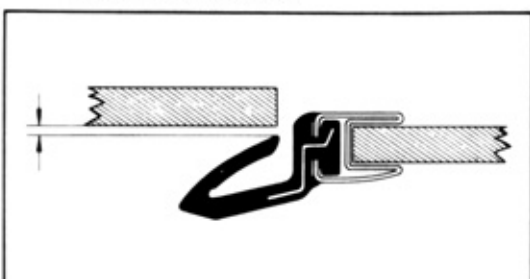


Fig. 3-80



5. When there is gap between glass and quarter panel.

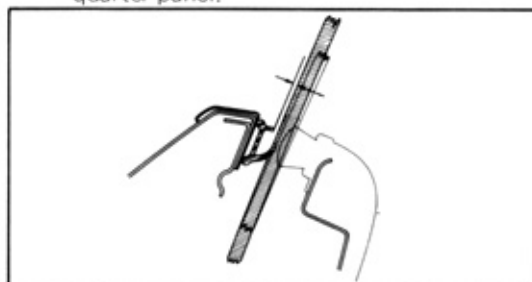


Fig. 3-81



6. When glass is not flush with weatherstrip.

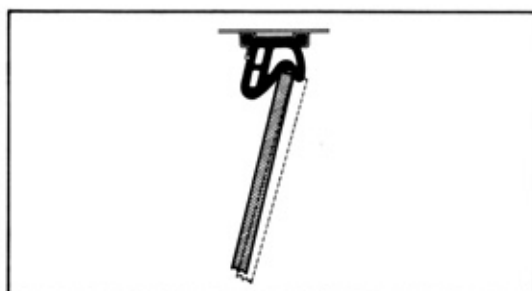


Fig. 3-82



7. When there is excessive looseness in lateral direction.

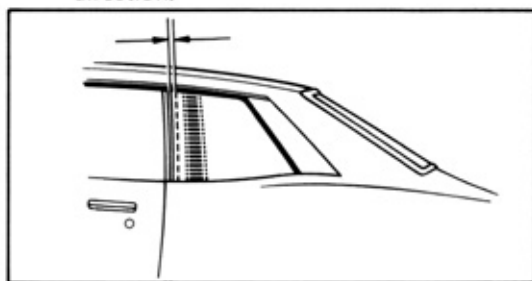
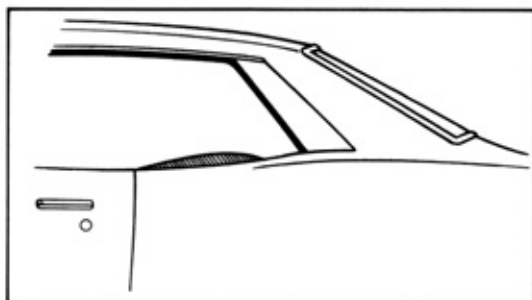


Fig. 3-83

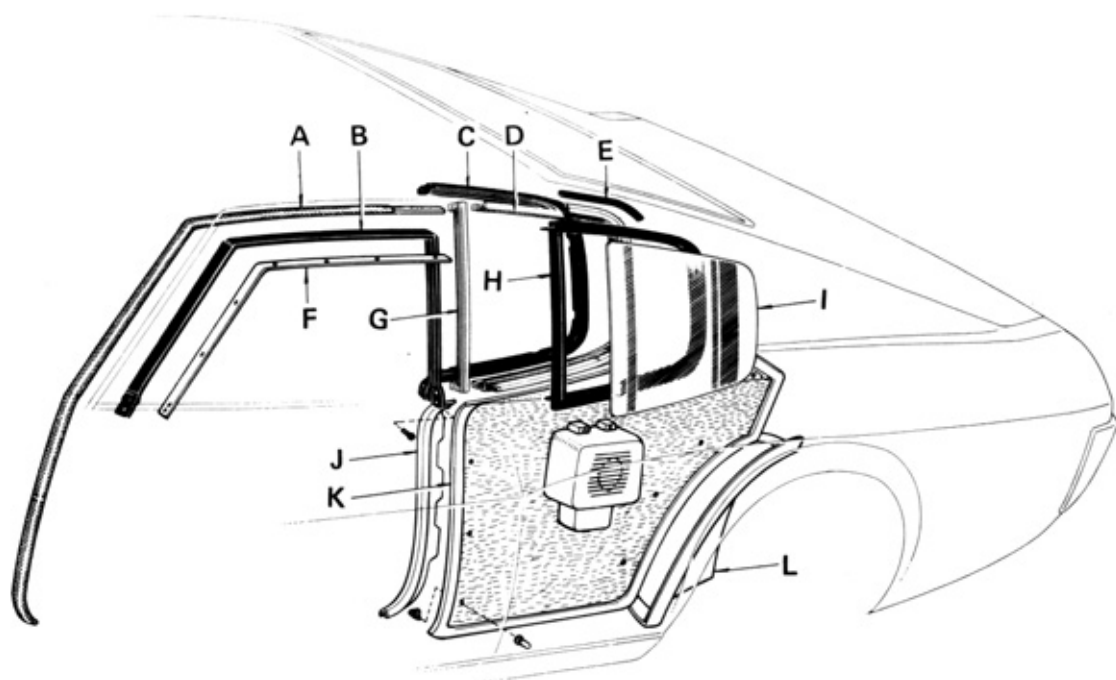


8. When glass is not lowered sufficiently.



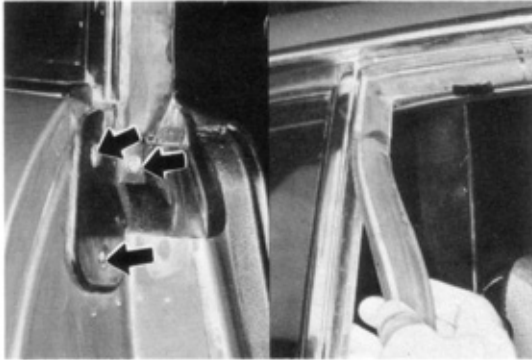
QUARTER WINDOW (LIFTBACK)

Fig. 3-84



- | | | | |
|---|--------------------------------------|---|------------------------------|
| A | Roof Side Rail Garnish | G | Quarter Window Front Channel |
| B | Roof Side Rail Weatherstrip | H | Quarter Window Weatherstrip |
| C | Quarter Window Channel Seal | I | Quarter Window Glass |
| D | Quarter Window Channel | J | Door Opening Trim Rear Trim |
| E | Quarter Window Channel Seal | K | Quarter Inside Trim Board |
| F | Roof Side Rail Weatherstrip Retainer | L | Wheel House Trim Cover |

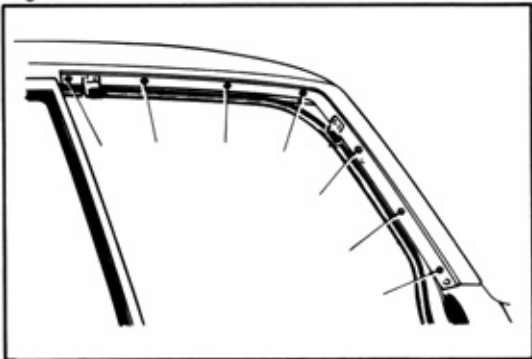
Fig. 3-85



REAR QUARTER WINDOW GLASS REMOVAL

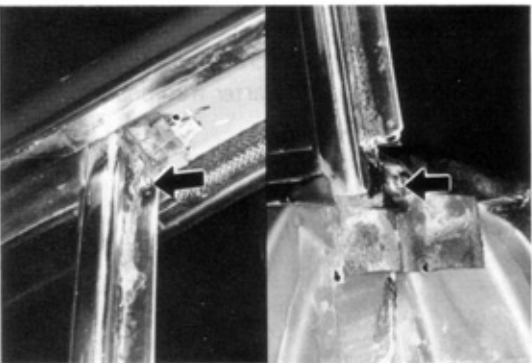
1. Remove roof side rail weatherstrip. Remove the three attaching screws and peel off the weatherstrip from the quarter window front channel and roof side rail weatherstrip retainer.

Fig. 3-86



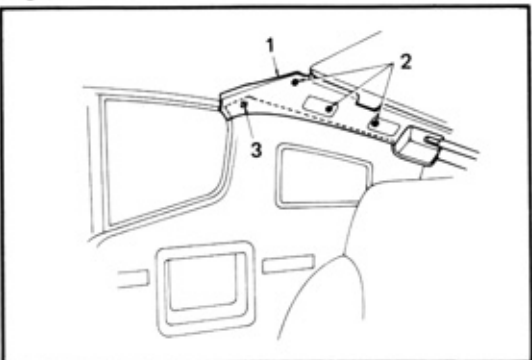
2. Remove roof side rail weatherstrip retainer. Remove the 7 mounting screws and peel off the retainer from the adhesive.

Fig. 3-87



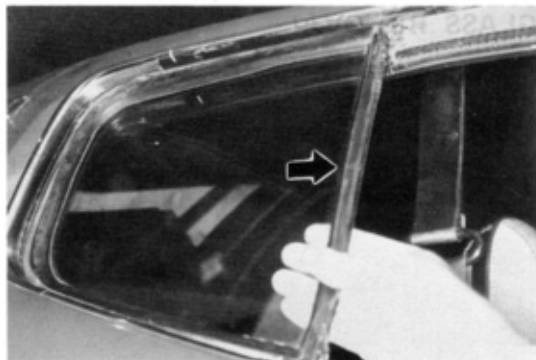
3. Remove quarter window front channel. Remove the two screws from the upper and lower parts and take off the quarter window front channel.

Fig. 3-88



4. Remove deck side front garnish (1).
 - (1) Loosen the three mounting screws (2) and take off the deck side front garnish.
 - (2) Remove the screw (3) attaching the quarter trim board, and raise up the quarter trim board from the quarter window weatherstrip.

Fig. 3-89



- Remove quarter window glass. Pull the quarter window glass and weatherstrip out toward the front, and remove the quarter window glass.

REAR QUARTER WINDOW GLASS INSTALLATION

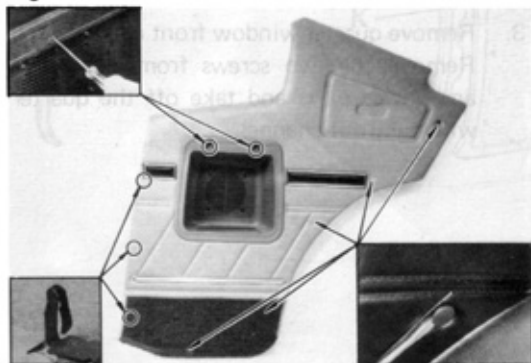
Perform the removal in reverse order.

**SEE
REAR QUARTER WINDOW
GLASS REMOVAL PAGE 3-31**

QUARTER WINDOW CHANNEL REMOVAL

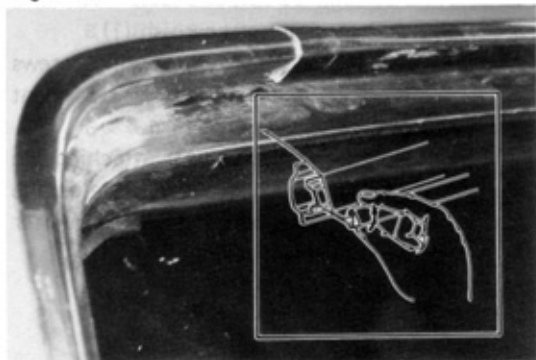
- Remove roof side rail weatherstrip retainer.
- Remove deck side front garnish. Perform first 2 steps and 4th step in Quarter Window Glass Removal page 3-31.

Fig. 3-90



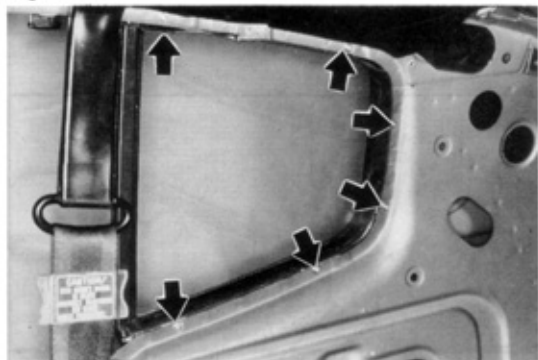
- Remove quarter trim board. Remove the four screws and five retainers, and take off the quarter trim board.

Fig. 3-91



- Remove roof drip side finish moulding. Remove the moulding by holding its rear end by hand and twisting it up toward the upper side of body.

Fig. 3-92



5. Remove quarter window assembly. Remove the six mounting screws, and draw out the quarter window assembly toward the front side.

Fig. 3-93



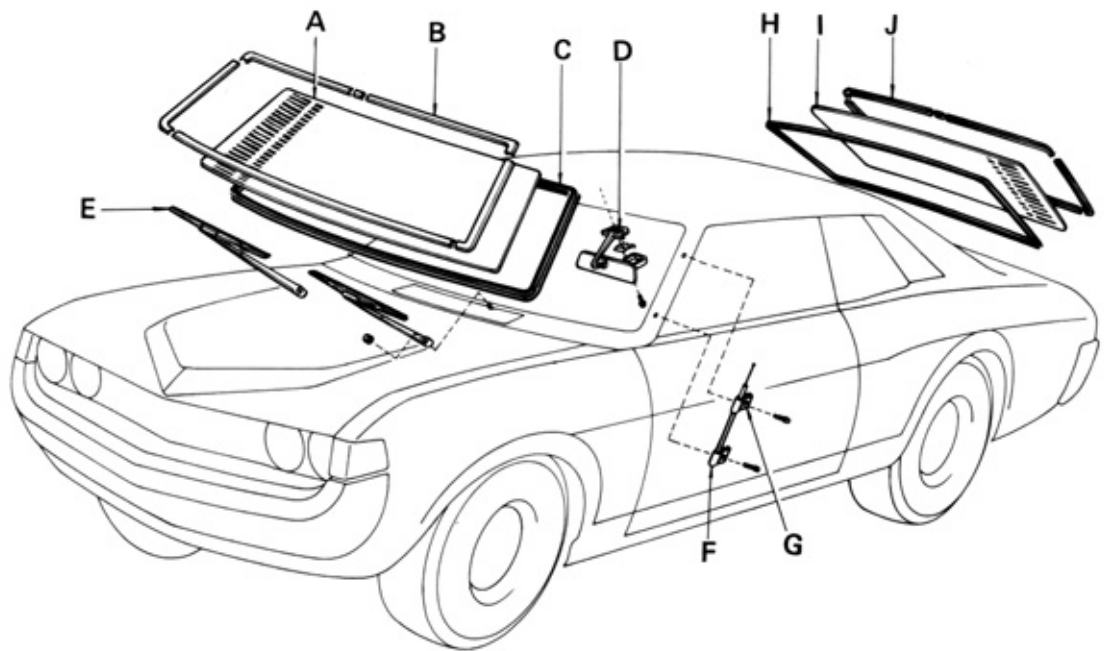
6. Disassemble quarter window. Remove the two screws attaching the quarter window from channel, and take off the quarter window.

QUARTER WINDOW CHANNEL INSTALLATION

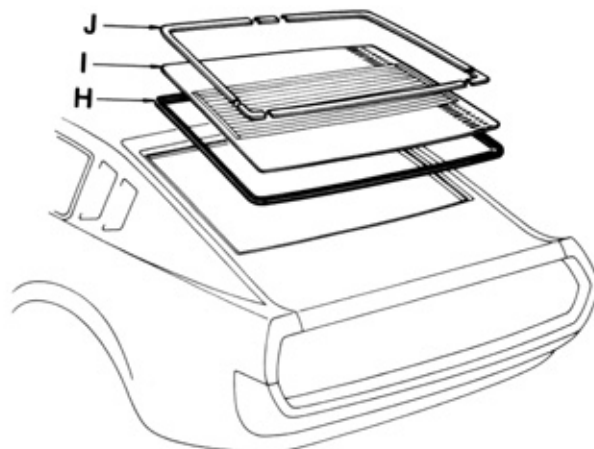
Perform the removal in reverse order.

WINDSHIELD

Fig. 3-94



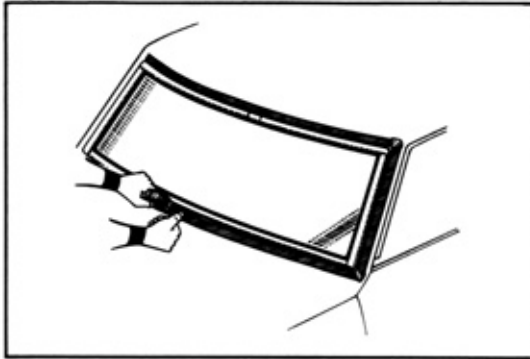
LIFTBACK



- A Front Windshield Glass
- B Windshield Moulding
- C Front Windshield Weatherstrip
- D Inner Rear View Mirror
- E Wiper Arms & Blade

- F Pillar Antenna Pole
- G Antenna Holder
- H Rear Window Weatherstrip
- I Rear Window Glass
- J Rear Window Moulding

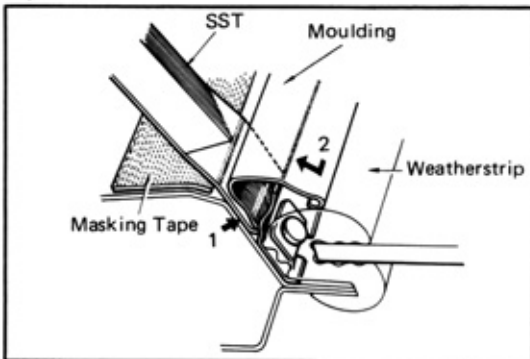
Fig. 3-95



WINDSHIELD GLASS REMOVAL

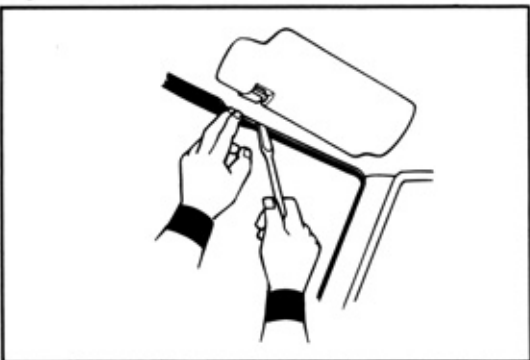
1. Remove the wiper arms, radio antenna and inner rear view mirror.
2. Use masking tape around the moulding to prevent scratching the body.

Fig. 3-96



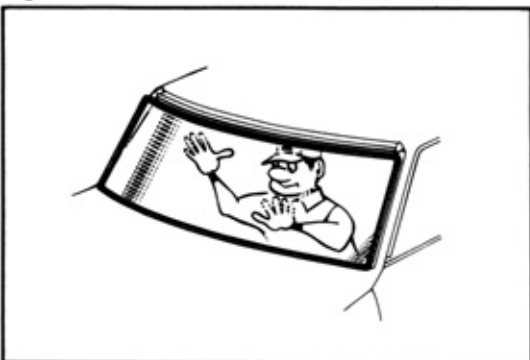
3. Remove the moulding, using SST [09806-30010].

Fig. 3-97



4. From inside the car, push out the weatherstrip upper side toward the outside with a screwdriver.

Fig. 3-98

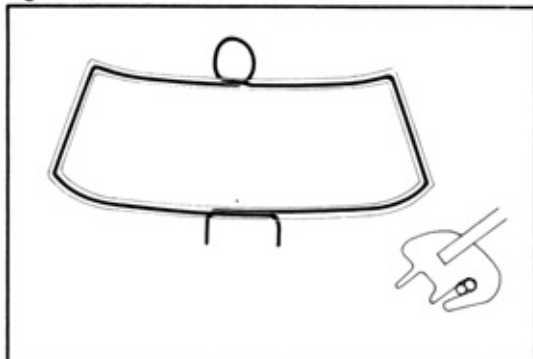


5. Push the glass surface near the upper side of the weatherstrip toward the outside, and remove the glass with the weatherstrip attached.

– Note –

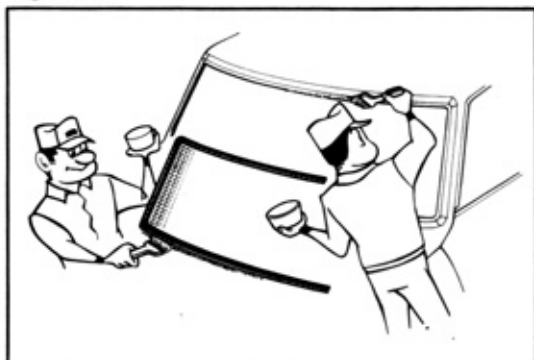
Push the glass out using uniform force.

Fig. 3-99

**WINDSHIELD GLASS INSTALLATION**

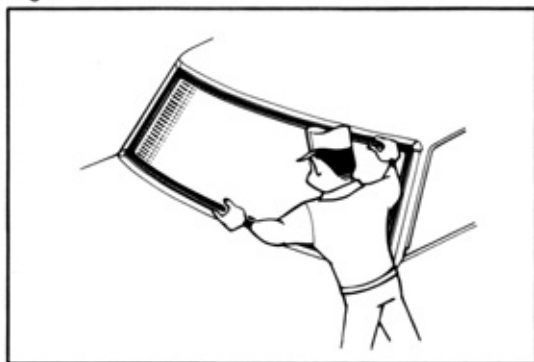
1. Mount the weatherstrip on the glass, and fit the installation cord in the weatherstrip body groove.

Fig. 3-100



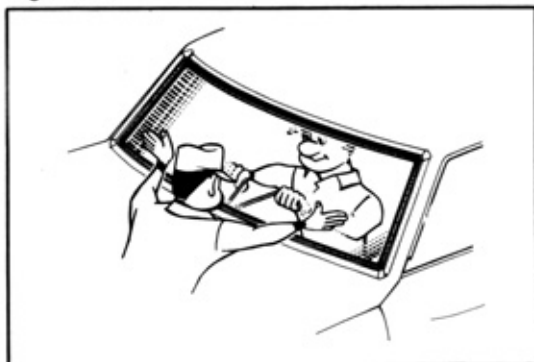
2. Apply soapy water on the weatherstrip and body contacting surfaces.

Fig. 3-101



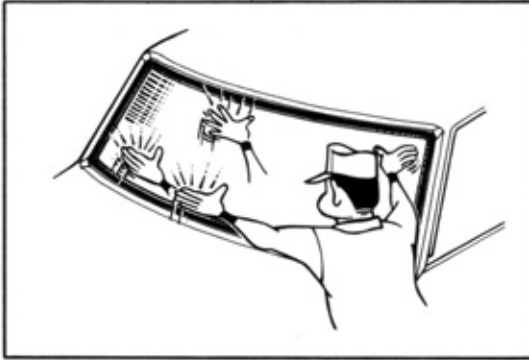
3. Position the windshield glass accurately on the body.

Fig. 3-102



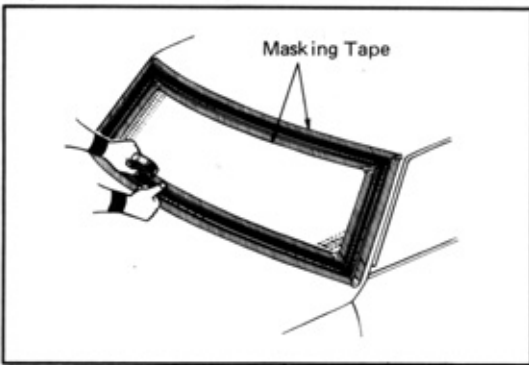
4. Pull the cords from inside the body, and at the same time, tap the glass surface near the weatherstrip with the palm of the hand from the outside, and begin installing from the lower center.

Fig. 3-103



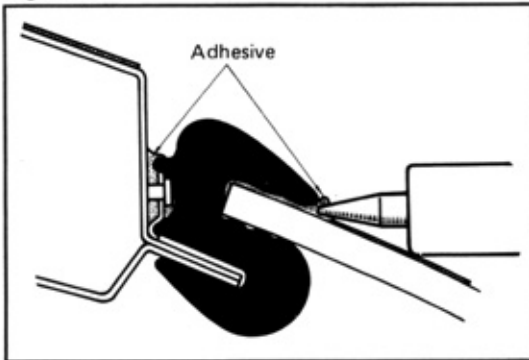
5. After installing the glass, tap it from the outside with the palm of the hand so it is fully seated.

Fig. 3-104



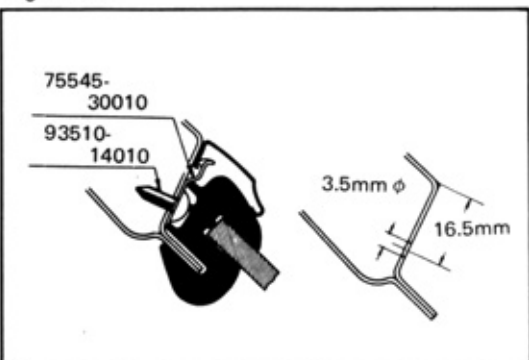
6. Fill adhesive into the space between the weatherstrip and body, and between the weatherstrip and glass.
 - (1) Place masking tape on the windshield glass beforehand so as to allow easy removal of adhesive that oozes out.

Fig. 3-105



- (2) Fill in the adhesive from the outside.

Fig. 3-106



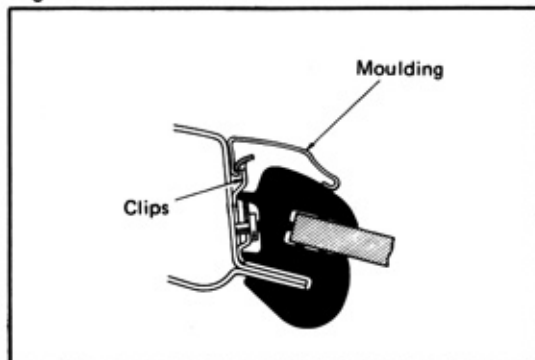
7. Install the clips. In case the weld stud (for attaching clip) is damaged or missing, proceed as follows:
 - (1) Remove the windshield glass and drill a hole for installing clip as shown.
 - (2) Install clip [75545-30010] and screw [93510-14010].

75545-30010

93510-14010

3.5mm ϕ
16.5mm

Fig. 3-107



8. Install the windshield mouldings.
9. Install the wiper arms, radio antenna and inner rear view mirror.

**SEE
WINDSHIELD GLASS REMOVAL
& INSTALLATION PAGE 3-35**

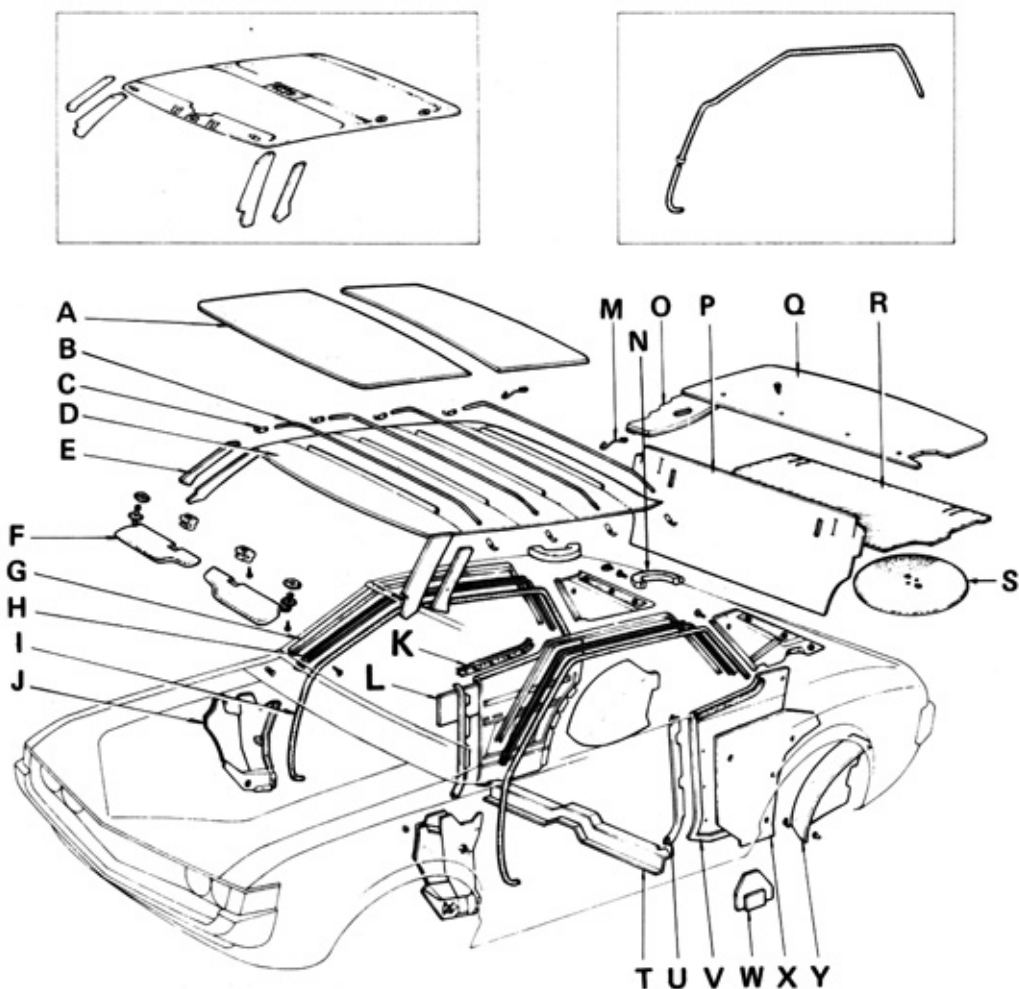
BACK WINDOW GLASS

Removal and installation of back window glass is performed by same procedures for removing and installing windshield glass page 3-35.

INTERIOR

HARDTOP SERIES

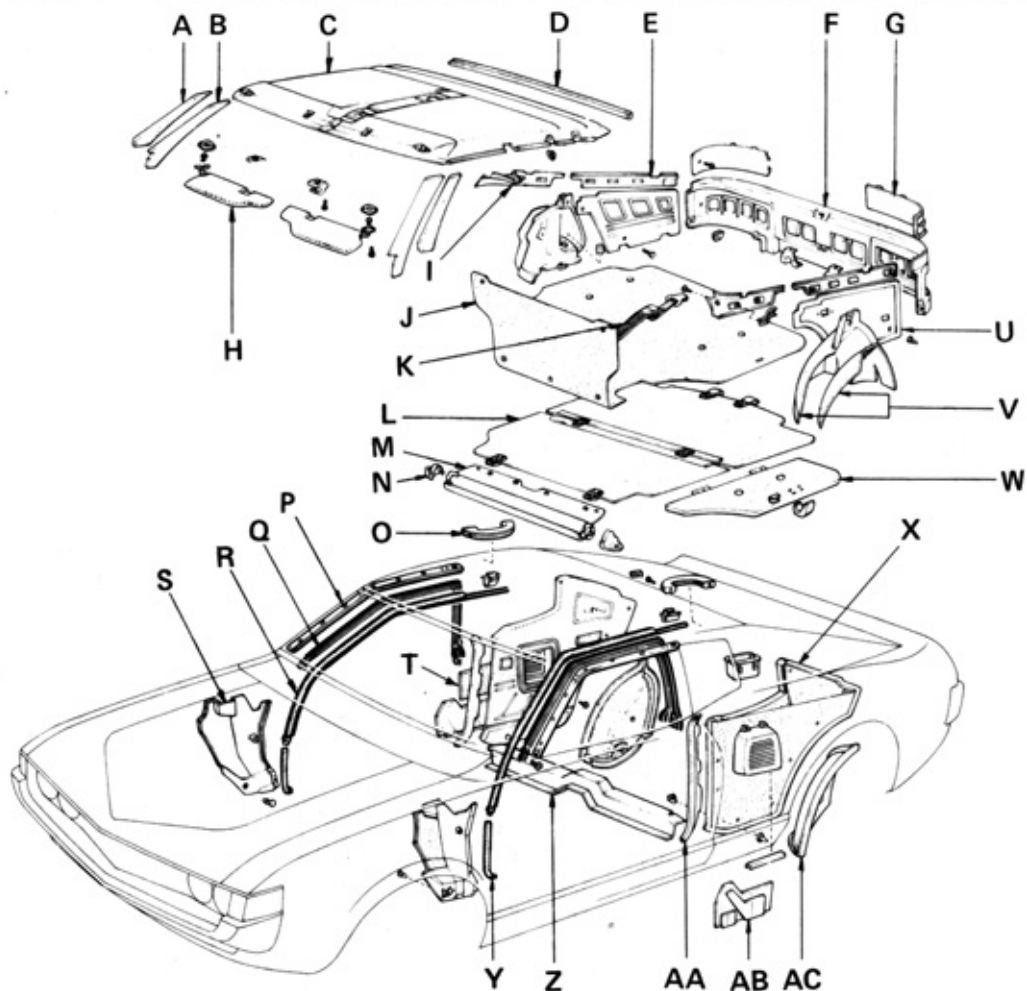
Fig. 3-108



- | | | | |
|---|--------------------------------------|---|-------------------------------------|
| A | Roof Silencer Pad | N | Assist Grip |
| B | Roof Headlining Support | O | Luggage Compartment Side Cover |
| C | Headlining Support Retainer | P | Luggage Compartment Partition Board |
| D | Roof Headlining | Q | Package Tray Trim Panel |
| E | Roof Headlining Front Garnish Pad | R | Luggage Compartment Mat |
| F | Sun Visor | S | Spare Wheel Cover |
| G | Roof Side Rail Weatherstrip Retainer | T | Center Floor Crossmember Garnish |
| H | Roof Side Rail Weatherstrip | U | Door Opening Rear Trim |
| I | Door Opening Trim Moulding | V | Quarter Inside Trim Board |
| J | Cowl Side Trim Board | W | Quarter Service Hole Cover Rear |
| K | Rear Quarter Inner Weatherstrip | X | Quarter Service Hole Cover Front |
| L | Quarter Panel Silencer Pad | Y | Quarter Wheel Housing Trim Pad |
| M | Roof Headlining Support Hook | | |

LIFTBACK SERIES

Fig. 3-109



- | | | | |
|---|-----------------------------------|----|--------------------------------------|
| A | Roof Headlining Front Garnish Pad | P | Roof Side Rail Weatherstrip Retainer |
| B | Roof Headlining Front Garnish | Q | Roof Side Rail Weatherstrip |
| C | Roof Headlining | R | Roof Side Rail Garnish |
| D | Roof Headlining Rear Trim | S | Cowl Side Trim Board |
| E | Deck Side Rear Garnish | T | Quarter Panel Silencer Pad |
| F | Lower Back Panel Cover | U | Deck Side Trim Panel |
| G | Service Hole Cover | V | Deck Side Trim Cover |
| H | Sun Visor | W | Deck Board No. 2 |
| I | Deck Side Front Garnish | X | Quarter Inside Trim Board |
| J | Rear Seat Back Mat | Y | Door Opening Trim Moulding |
| K | Luggage Hold Down Belt | Z | Center Floor Crossmember Garnish |
| L | Deck Board | AA | Door Opening Rear Trim |
| M | Parcel Cover | AB | Quarter Service Hole Cover |
| N | Parcel Cover Retractor Protector | AC | Wheel Housing Trim Cover |
| O | Assist Grip | | |

**SEE
CARINA BODY – ROOF
HEADLINING REPLACEMENT
PAGE 2-31**

Fig. 3-110

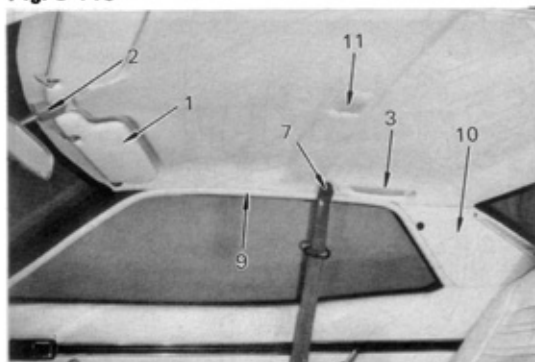


Fig. 3-111

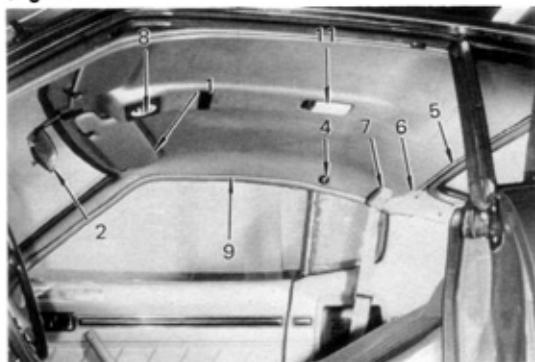


Fig. 3-112



ROOF HEADLINING REPLACEMENT (HANGING CEILING TYPE)

For replacement procedures, refer to CARINA BODY – Roof Headlining Replacement on page 2-31.

ROOF HEADLINING REPLACEMENT (FORMED ROOF TYPE)

1. Remove the following parts.
 - (1) Sun visors
 - (2) Inner rear view mirror
 - (3) Assist grip (Hardtop)
 - (4) Coat hook (Liftback)
 - (5) Roof headlining rear trim (Liftback)
 - (6) Deck side front garnish (Liftback)
 - (7) Seat Belts
 - (8) Map light (Liftback)
 - (9) Roof side rail garnish and retainer
 - (10) Back window side garnish cover (Hardtop)
 - (11) Interior light

2. Remove the roof headlining.
3. Install by performing the removal in reverse order.

INSTRUMENT PANEL

SAFETY PAD REMOVAL

Removal in the numbered order shown below.

Fig. 3-113

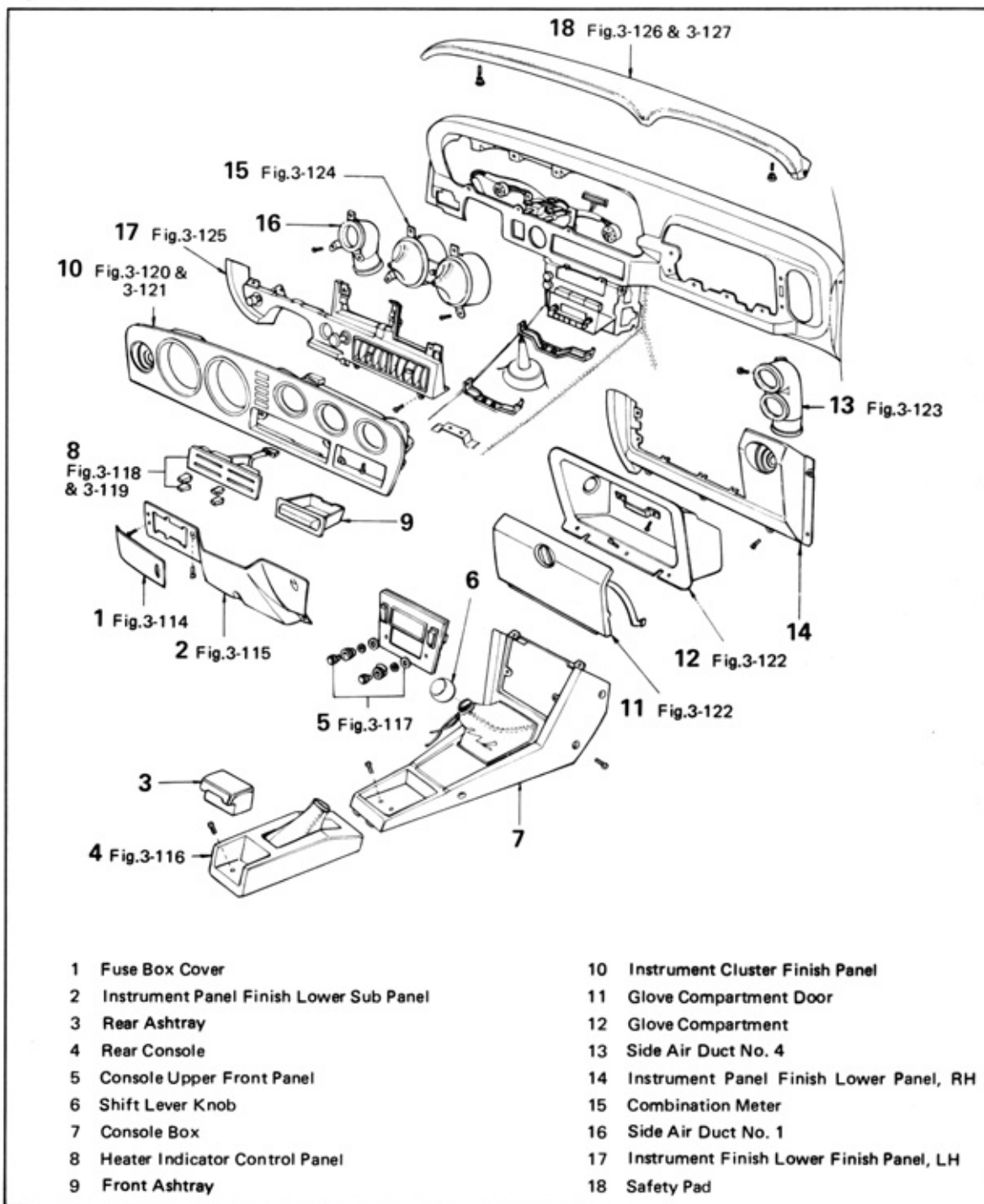
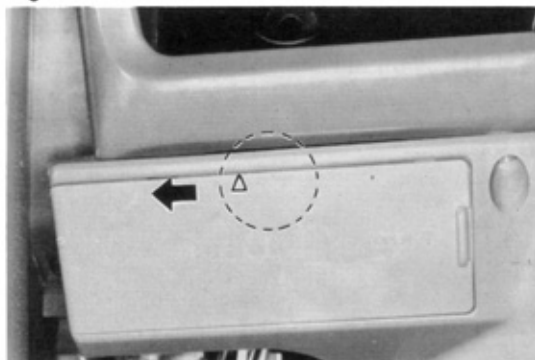
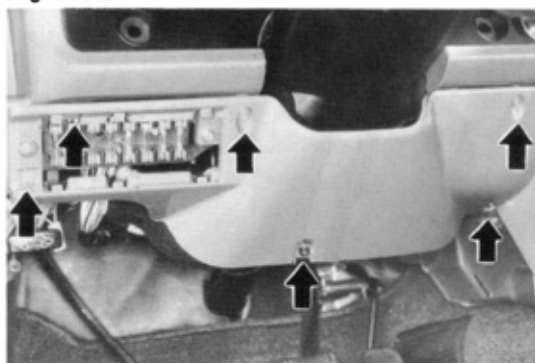


Fig. 3-114

**SAFETY PAD REMOVAL**

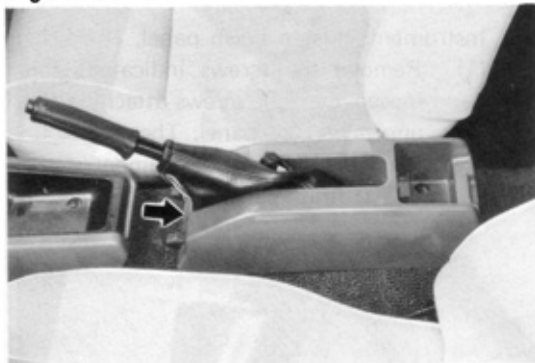
1. Fuse box cover (Item 1)
Slide the cover toward the outside, and after aligning the triangular mark, remove the cover.

Fig. 3-115



2. Instrument panel finish lower sub panel. (Item 2)
Remove one mounting screw from inside the fuse box cover and four mounting screws from the outer side.

Fig. 3-116



3. Rear console (Item 4)
Remove the rear ash receptacle. The loosen the exposed mounting screw and slide the rear console toward the rear.

Fig. 3-117



4. Console upper front panel (Item 5)
Pull off the radio knobs and remove the nut (1) holding down the shaft. Hold the upper and lower part of panel and pull it out.

Fig. 3-118



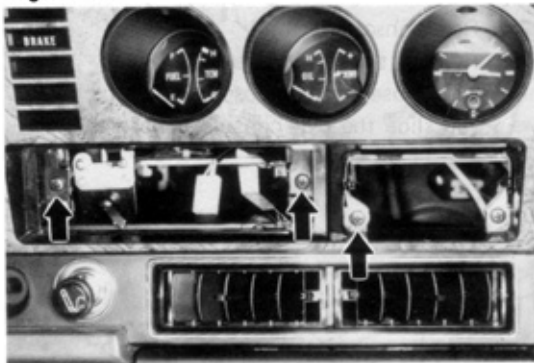
5. Heater indicator control panel (Item 8)
 (1) Pull out the four heater control lever knobs.

Fig. 3-119



- (2) Using a screwdriver, remove the heater control panel.

Fig. 3-120



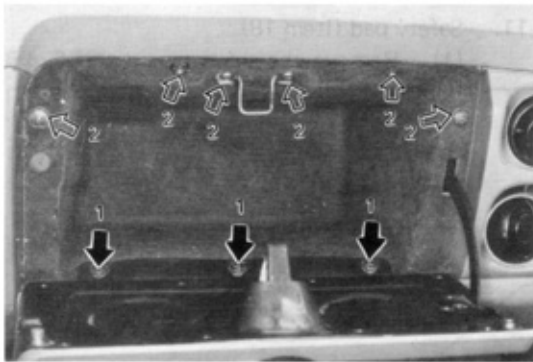
6. Instrument cluster finish panel. (Item 10)
 (1) Remove the screws indicated, and loosen the four screws attaching the upper part of panel. Then pull out the lower part of instrument panel cluster finish panel.

Fig. 3-121



- (2) Pull out the connector from the wiring socket at back side of instrument panel cluster finish panel, and remove the instrument cluster finish panel.

Fig. 3-122



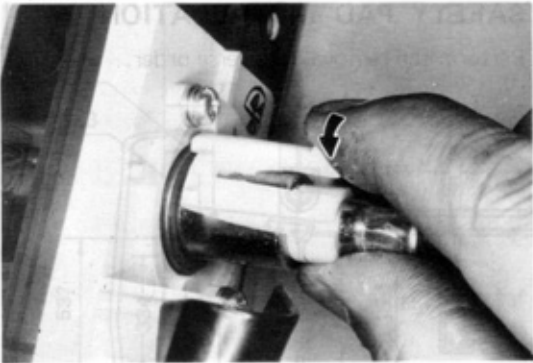
7. Glove compartment & door (Items 11 & 12)
 - (1) Remove arrow mark 1, and take off the glove compartment door.
 - (2) Remove arrow mark 2, and take off the glove compartment.

Fig. 3-123



8. Side air duct No. 4 (Item 13)
 - (1) Remove the two mounting screws.
 - (2) Remove the side air duct No. 4 at the time the instrument panel finish lower right is removed.

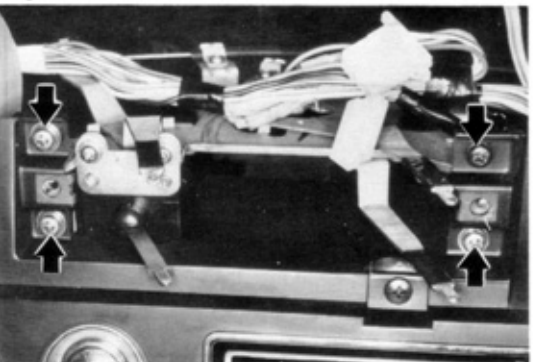
Fig. 3-124



9. Combination meter (Item 15)

Remove after disconnecting the socket and speedometer cable at the meter back side.

Fig. 3-125



10. Instrument lower finish panel. (Item 17)

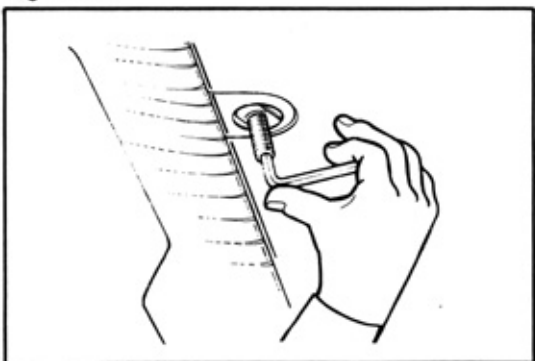
Separate from heater control assembly.

Fig. 3-126



11. Safety pad (Item 18)
(1) Remove the six nuts and stud bolts.

Fig. 3-127



- (2) Remove the stud bolts with hexagon wrench.



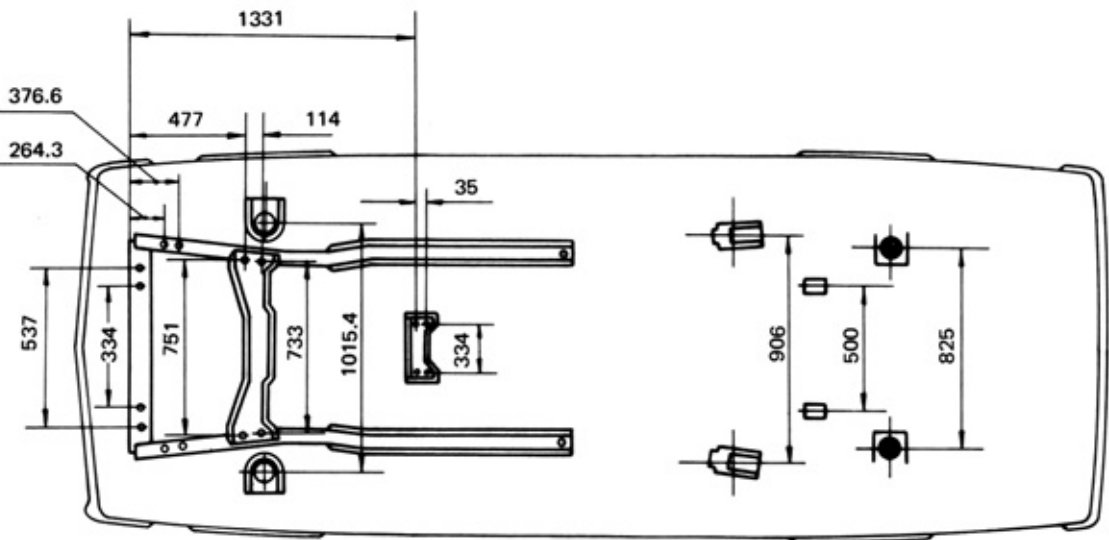
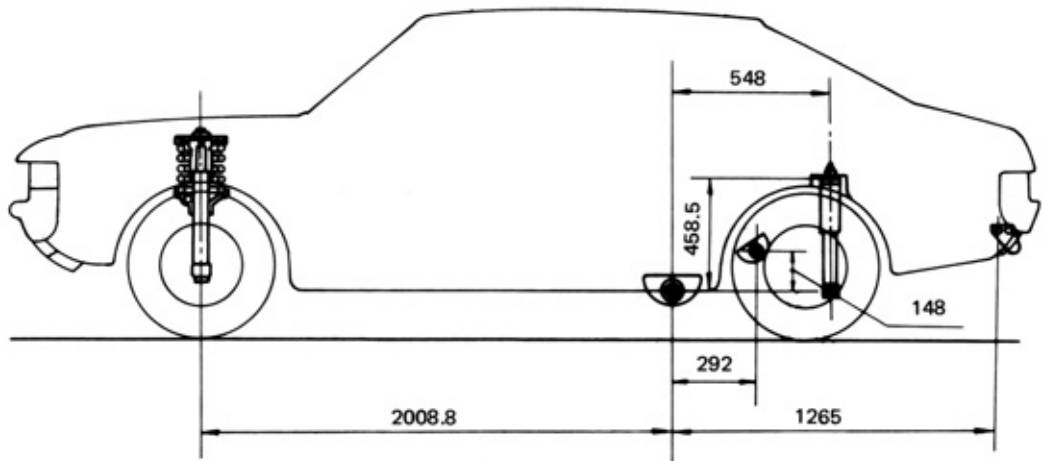
SAFETY PAD INSTALLATION

Perform the removal in reverse order.

IMPORTANT BODY DIMENSIONS

Fig. 3-128

All dimensions are shown in mm.



(mm)

